

# 1

## Linear Range

- 1.01 General Information: Components**
- 1.02 General Information: Installation Setting Out**
- 1.03 Planning: Corner base units & wall corner**
- 1.04 Profile fitting: Base Units**
- 1.05 Profile fitting: Tall Units**
- 1.06 Blender panel: Base end return**
- 1.07 Blender panel: Island end return**
- 1.08 Fixing Strip: Oven Housings**
- 1.09 Integrated appliance fitting: Base Unit**
- 1.10 Base Units: Filler Options**
- 1.11 Tall Units: Filler Option**

# Linear Range Installation Guide

## 1.01 General Information: Components

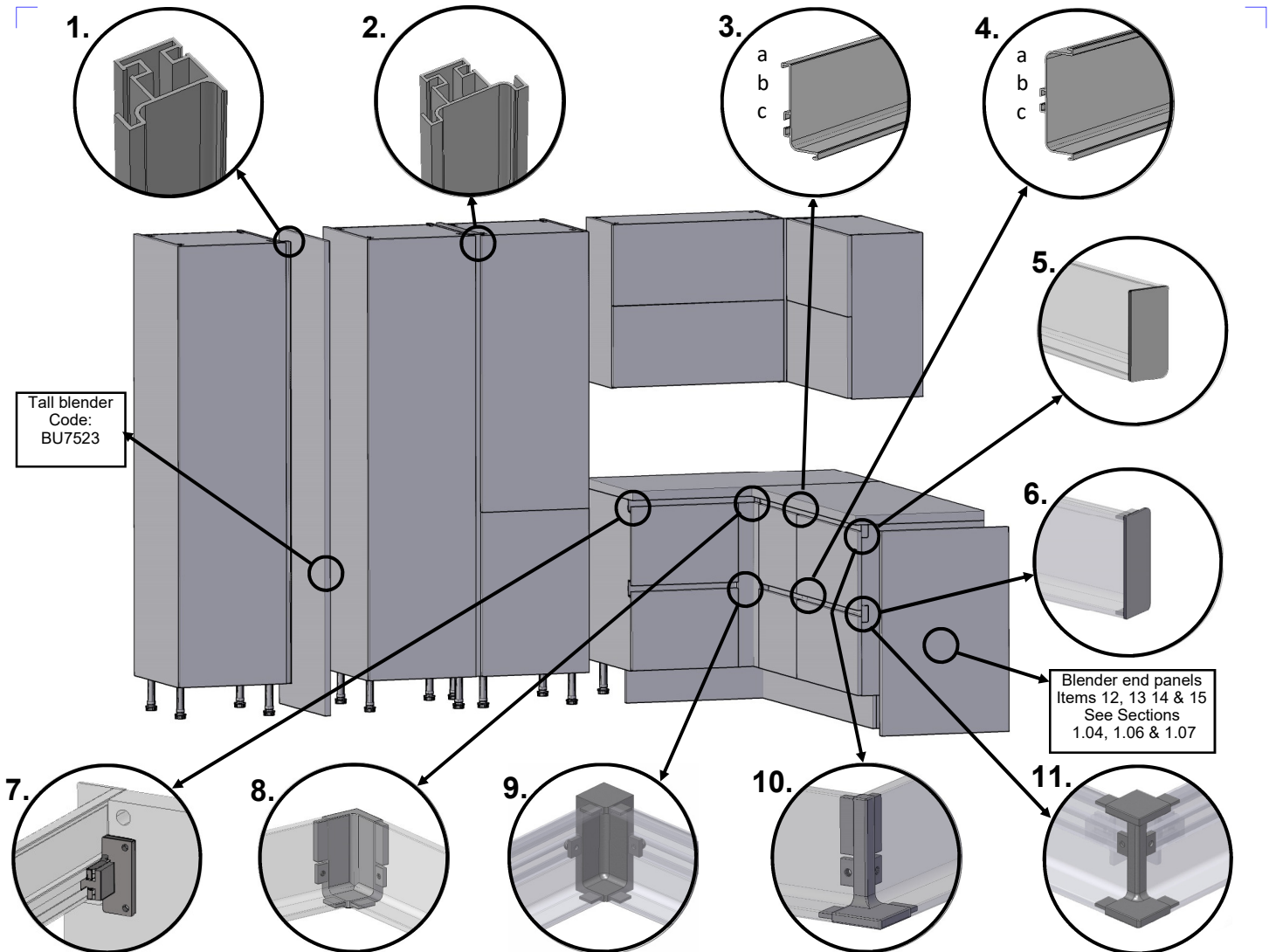

1:	Handle profile for stand alone tall unit	Code: LNENDTRIM22	Length: 2225mm (See 1.05)
2:	Handle profile for side by side tall units	Code: LNCTRTRIM22	Length: 2225mm (See 1.05)
3a:	Top handle profile	Code: LNTOPTRIM6	Length: 600mm
3b:	Top handle profile	Code: LNTOPTRIM19	Length: 1900mm
3c:	Top handle profile	Code: LNTOPTRIM38	Length: 3800mm
4a:	Middle handle profile for drawer units	Code: LNMIDTRIM6	Length: 600mm
4b:	Middle handle profile for drawer units	Code: LNMIDTRIM19	Length: 1900mm
4c:	Middle handle profile for drawer units	Code: LNMIDTRIM38	Length: 3800mm
5:	Top profile end cap	Code: LNTOPCAP	Alternative to blenders
6:	Middle profile end cap	Code: LNMIDCAP	Alternative to blenders
7:	Screw on fixing clips (pair)	Code: LNFIXCLIP	(See section 1.04)
8:	Top Internal corner joint	Code: LNINTCNR	(See section 1.04)
9:	Middle Internal corner joint	Code: LNMIDINTCNR	(See sections 1.04, 1.06 & 1.07)
10:	Top External corner	Code: LNEXTCNR	(See sections 1.04, 1.06 & 1.07)
11:	Middle External corner	Code: LNMIDEXTCNR	(See section 1.06)
12:	Blender panel: Base end return (570 unit 720h)	Code: BBU6572	(As shown above)
13:	Blender panel: Base end (Full height Floor to underside of top)	Code: BBU6592	(See section 1.07)
14:	Blender panel: Island end return (570 & 285 units 720h)	Code: BISL72	(See section 1.07)
15:	Blender panel: Island end return (570 & 570 units 720h)	Code: BISL1272	(See section 1.07)

# Linear Range Installation Guide

## 1.02 General Information: Setting out & Installation

Please follow this guide to plan and install your Linear kitchen. Read in conjunction with all other instructions supplied with your kitchen. The following diagram shows the basic setting out of Linear units to suit the 2 heights of tall units. Worktops should be fitted after the handle trim installation. We recommend that all installation work should be undertaken by a competent fitter or joiner. All electrical fitting must be undertaken by a qualified electrician.

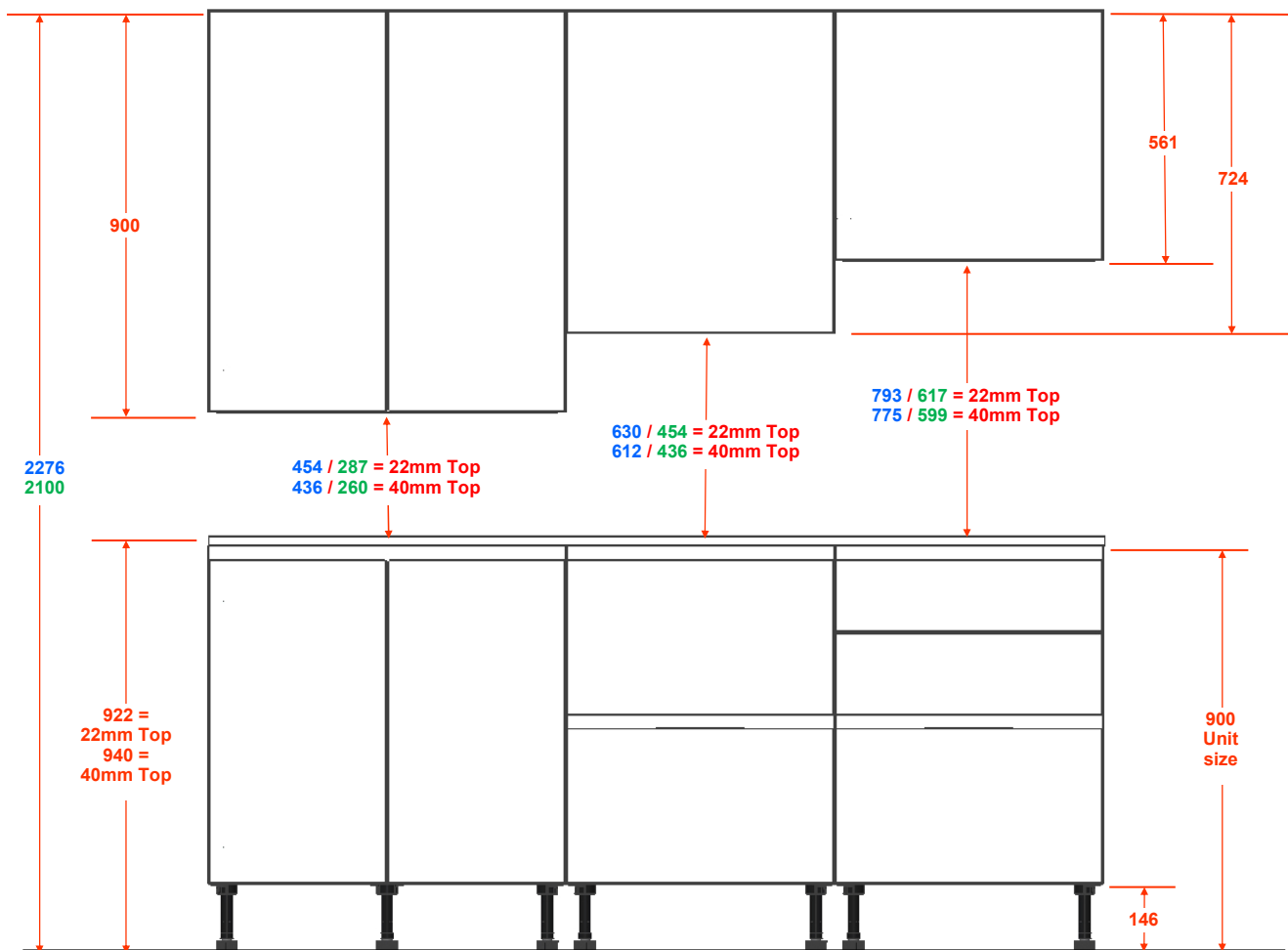

### IMPORTANT WALL FIXINGS



It is the responsibility of the customer:

- \* to ensure that the wall is of a suitable quality and structure to hold the unit fixing in place.
- \* to use the proper hardware fittings for the wall type.

Screw must be a minimum of 5mm diameter and raw plug should be appropriate for the wall.

We recommend two screw lengths:

- \* 60mm length for plasterboard walls with noggins/ patresses.
- \* 100mm length for brick and block walls with a suitable plug fixing.

All screws must make a solid fixing into either timber noggins, patress boards or through to walls. If there are no firm fixing points then seek expert advice before fitting the units.

UNDER NO CIRCUMSTANCES SHOULD PLASTERBOARD FIXINGS BE USED

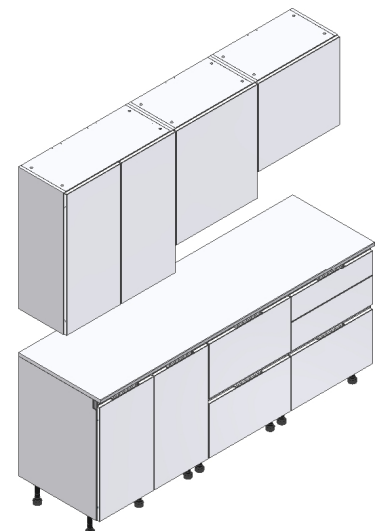

# Linear Range Installation Guide

## 1.02 General Information: Setting out & Installation - EDGE

Having chosen the appropriate fixings for the wall type to fix the wall mounting plates to the wall, determine the unit position on the wall. Always check for water pipes and electrics first. Mark out the bracket positions and drill the wall to suit the fixings.

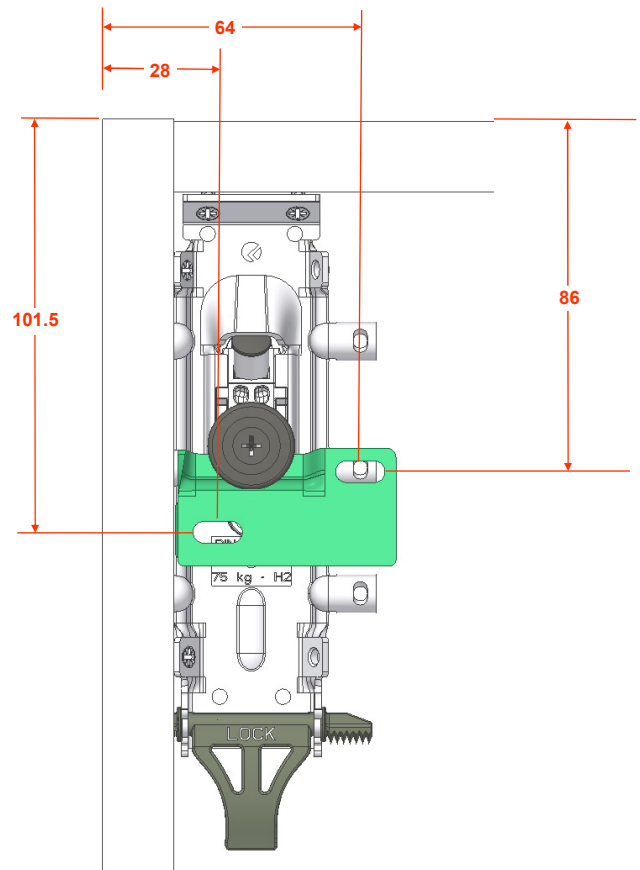
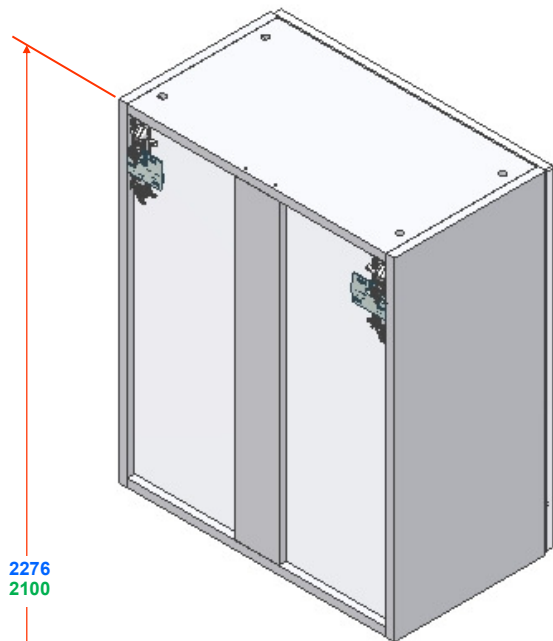

Ensure 2 wall fixings are used per plate. 

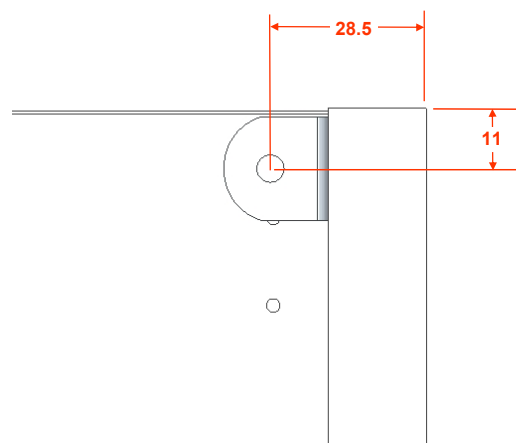
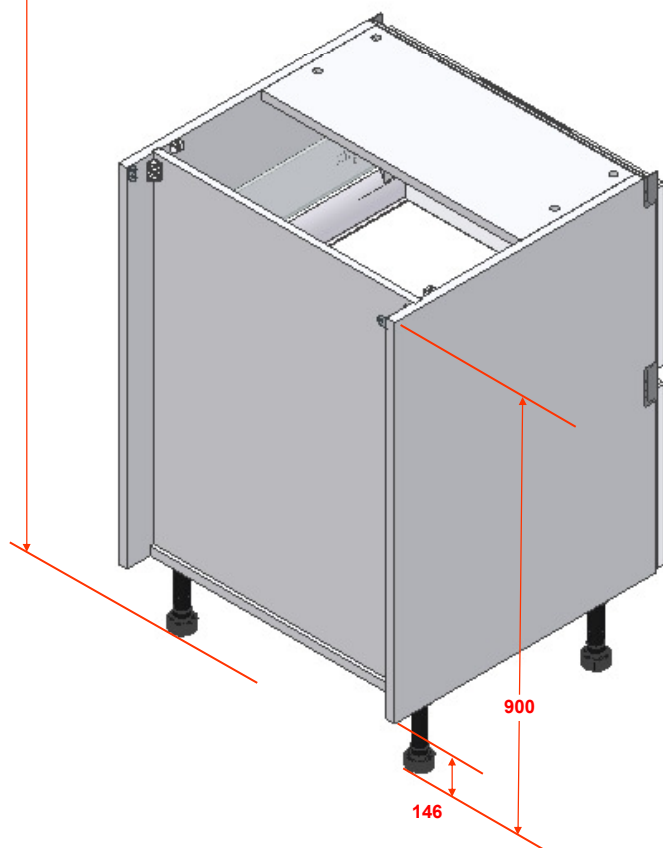

# Linear Range Installation Guide

## 1.02 General Information: Setting out & Installation - EDGE

LIBRA cabinet hangers allow users to adjust the cabinet vertically and horizontally. The 2 movements are 100% INDEPENDENT of each other and therefore make the adjustments much easier and more efficient.

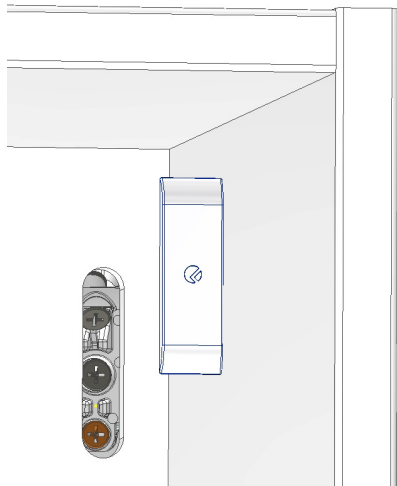

**1 Vertical Adjustment**  
**13mm**

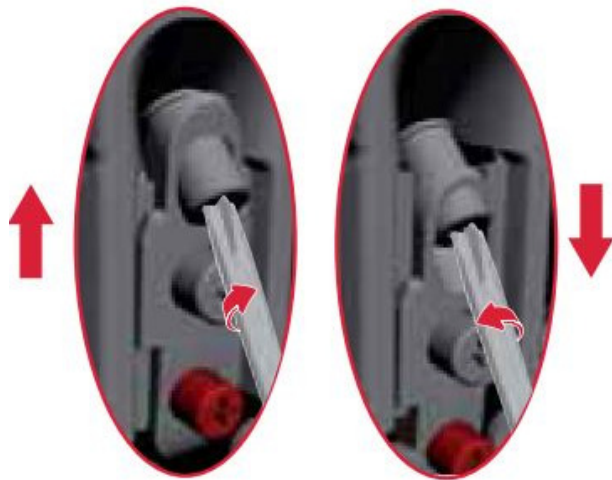

**2 In Depth Adjustment**  
**12mm**

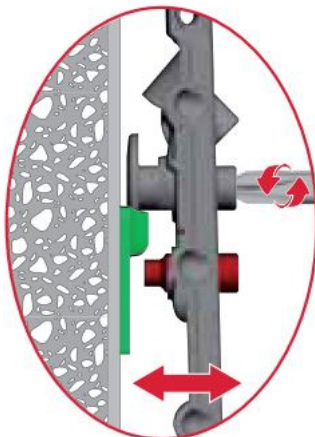

**3 Anti Turn over Locking**  
**Stop screwing the red bolt when it touches the plate**

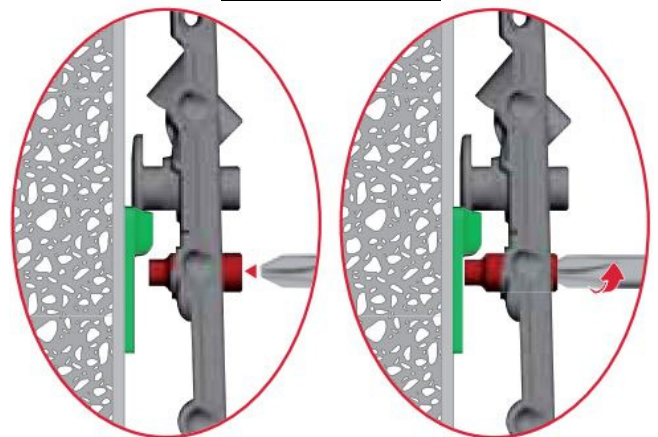

Slot for cross PZ2  
screwdriver



# Linear Range Installation Guide

## 1.02 General Information: Setting out & Installation - Premium

Having chosen the appropriate fixings for the wall type to fix the wall mounting plates to the wall, determine the unit position on the wall. Always check for water pipes and electrics first. Mark out the bracket positions and drill the wall to suit the fixings.

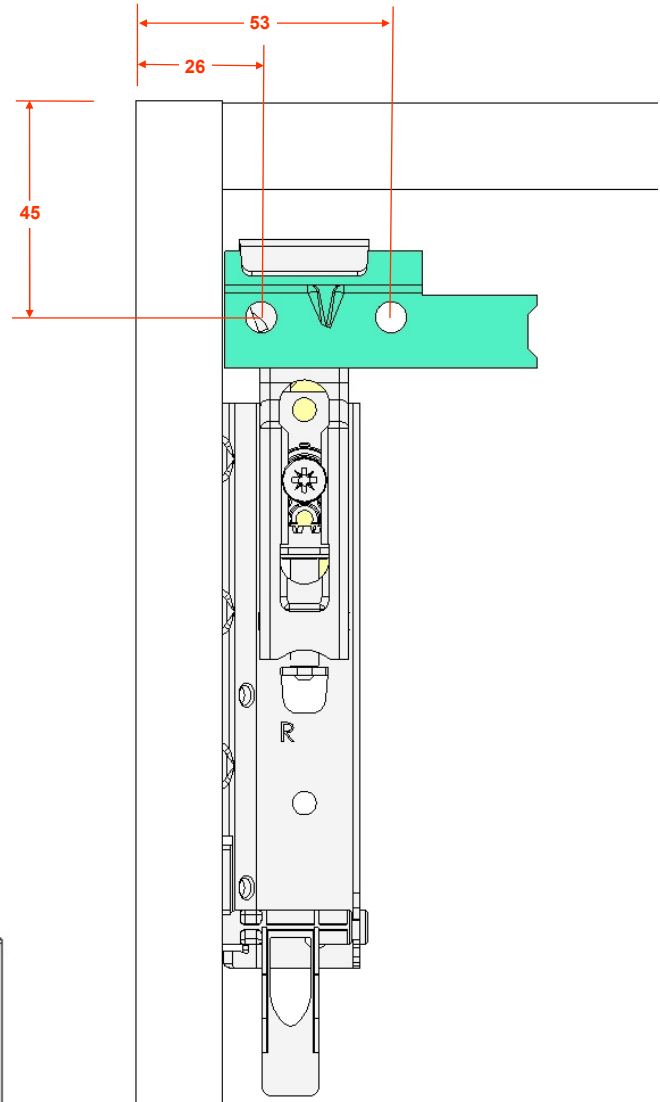
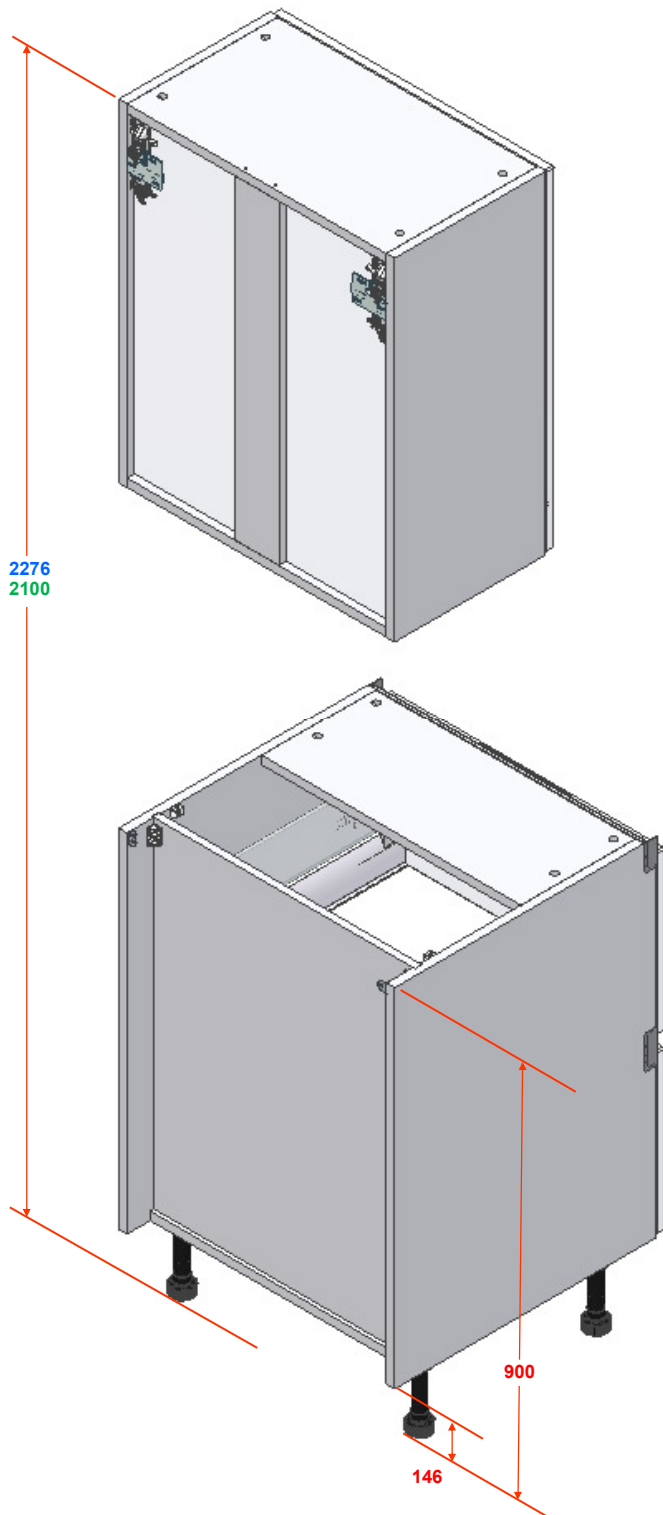

Ensure 2 wall fixings are used per plate. 

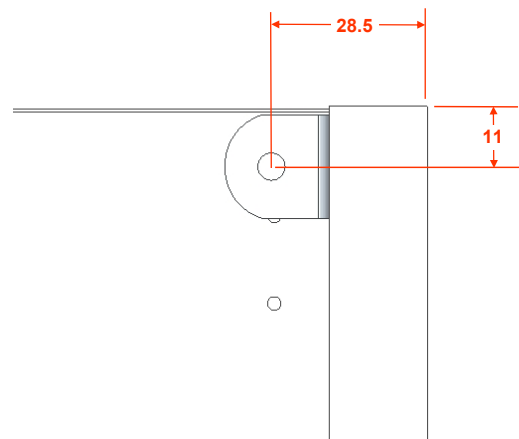

# Linear Range Installation Guide

## 1.02 General Information: Setting out & Installation - Premium

Traser 6 cabinet hangers allow users to adjust the cabinet vertically and horizontally. The 2 movements are 100% INDEPENDENT of each other and therefore make the adjustments much easier and more efficient.

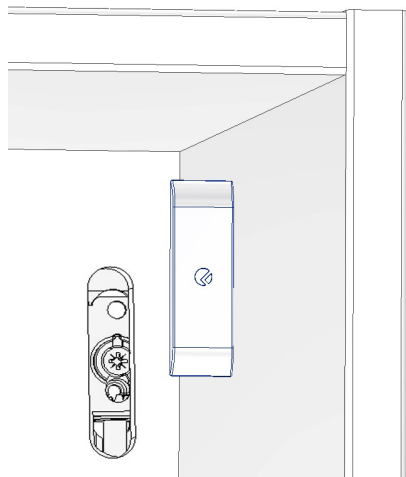

**1 Depth Adjustment**  
**25mm**



**2 Vertical Adjustment**  
**18mm**



Slot for  
Philips No 2 or  
a Pozi PZ2 screwdriver

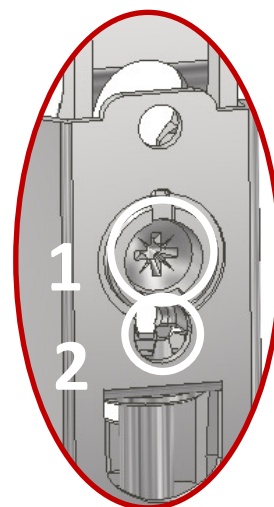
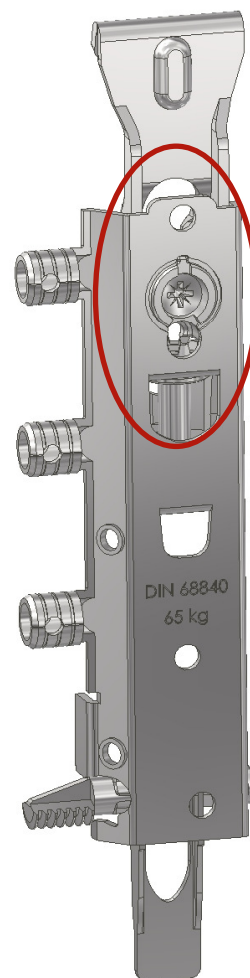

# Linear Range Installation Guide

## 1.02 General Information: Setting out

We recommend that an additional fixing is used through the rear support rail and the back panel. Fix through front of the unit into the wall using the appropriate fixing.

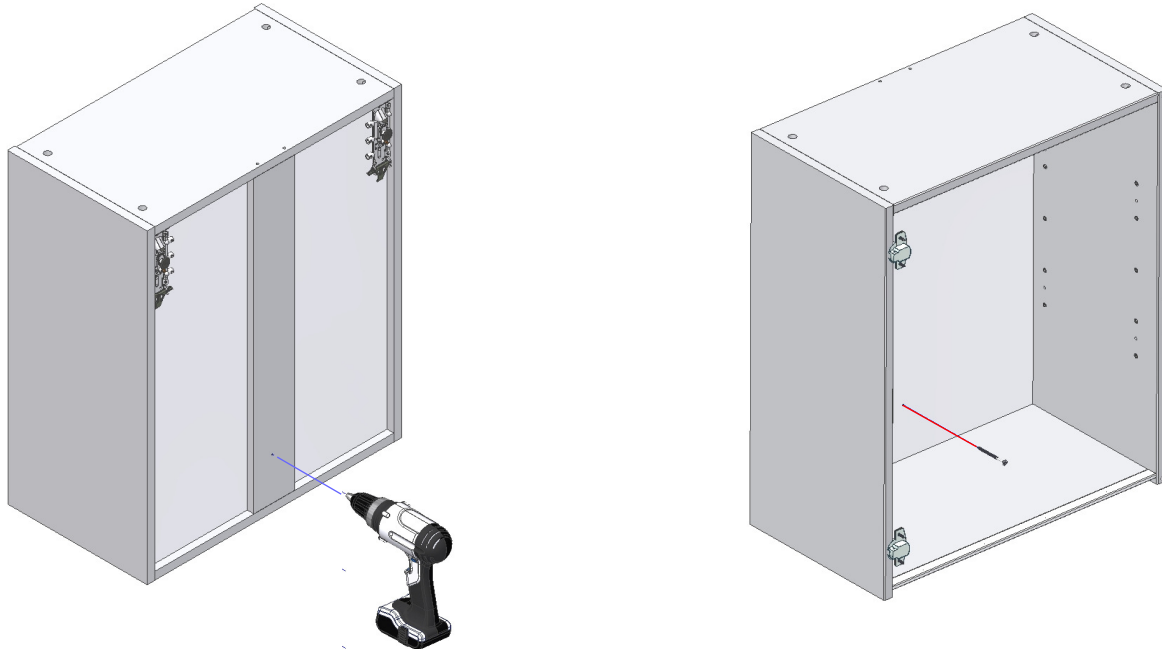

Units should be joined together.  
Drill a 3.0mm pilot hole and screw fix the units together. Where possible fix behind hinge plates and shelves as shown.

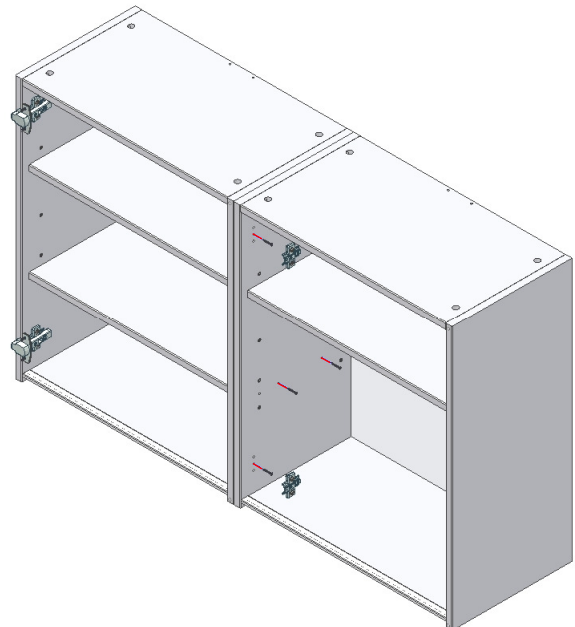
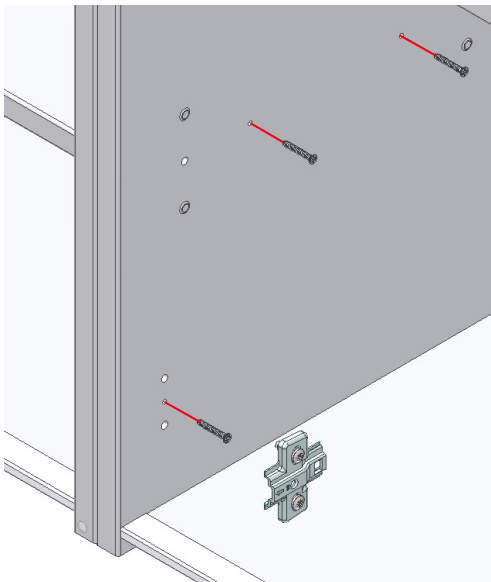

The weights shown below reflect testing to British Standard BS EN 6222 Test level 'H'  
Please ensure your units are not overloaded.

Wall Unit Width Maximum Weight Restrictions  
Single 150 to 600mm 20 Kgs  
Double 800 to 1000mm 30 Kgs





# Linear Range Installation Guide

## 1.03 Planning: Corner base units & wall corner

Please follow this guide to plan and install your Linear corner Base and Wall units.

### Base corner unit: (See table)

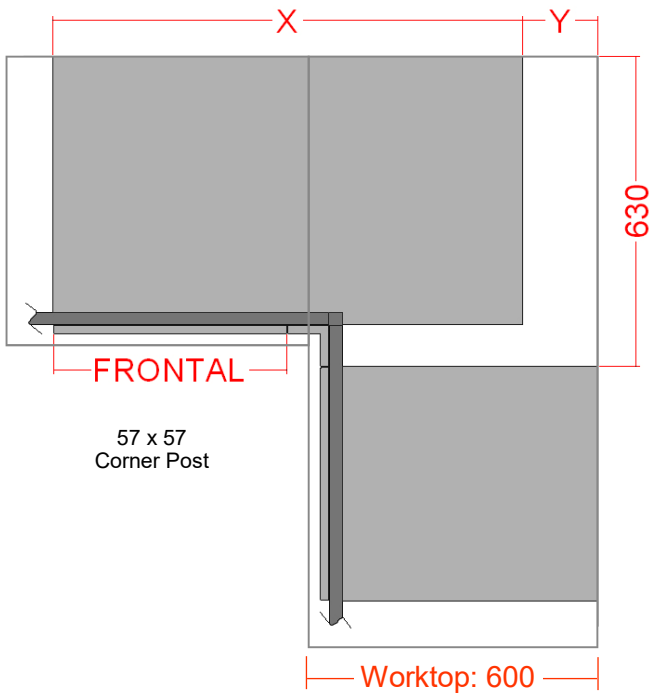

Corner base units				
Code	Style	Dim X	Dim Y	Frontal
CB86	A	800	230	400
CB86	B	800	130	300
CB86	C	800	330	500
CB96	A	900	180	450
CB106	A	1000	130	500
CB106	B	1000	30	400
CB106	C	1000	230	600
CB126	A	1200	30	600

### Base void corner:

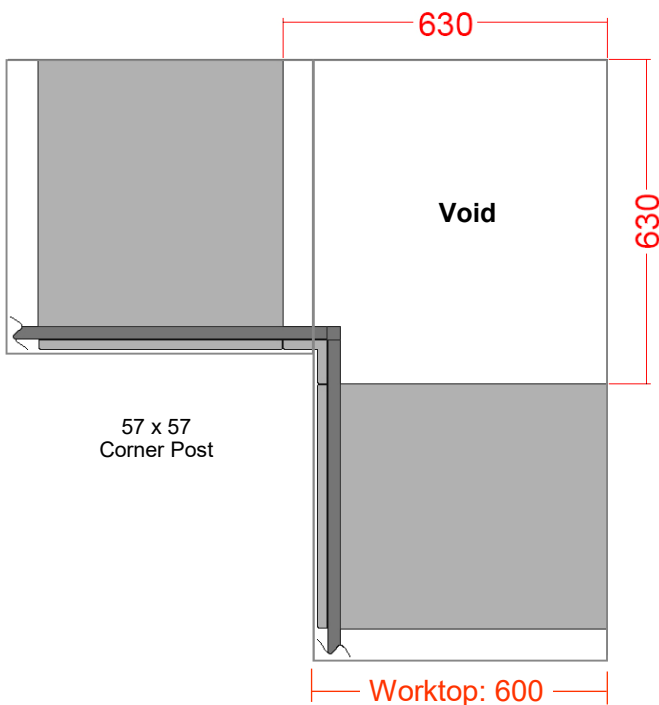

### Wall unit corner:

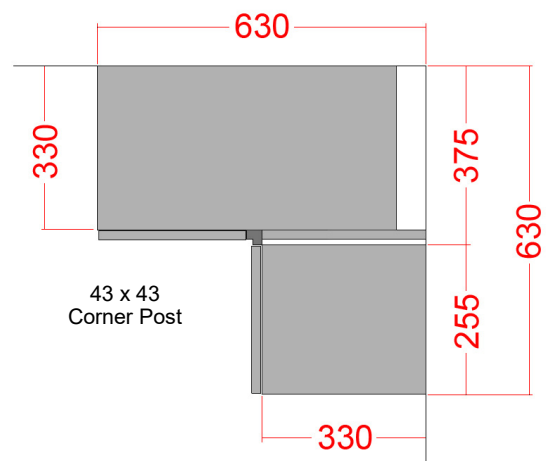

# Linear Range Installation Guide

## 1.04 Profile fitting: Base units

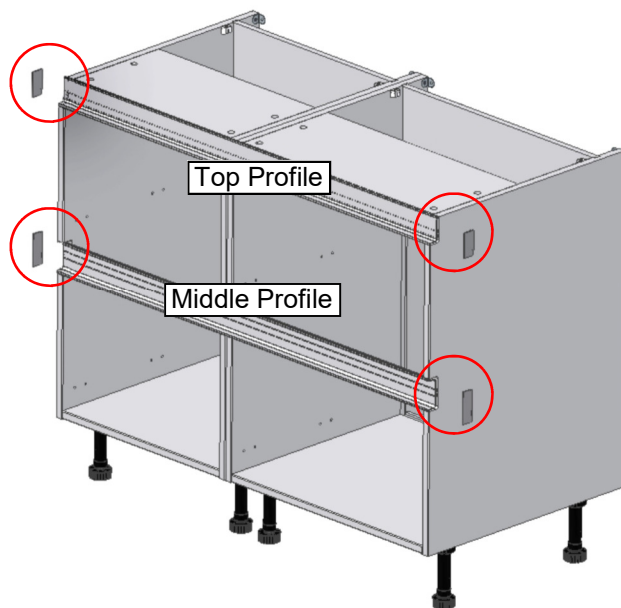

**IMPORTANT:** Seal cut-outs on carcass side panels using a suitable sealer

### Fixing Top profile to carcass:

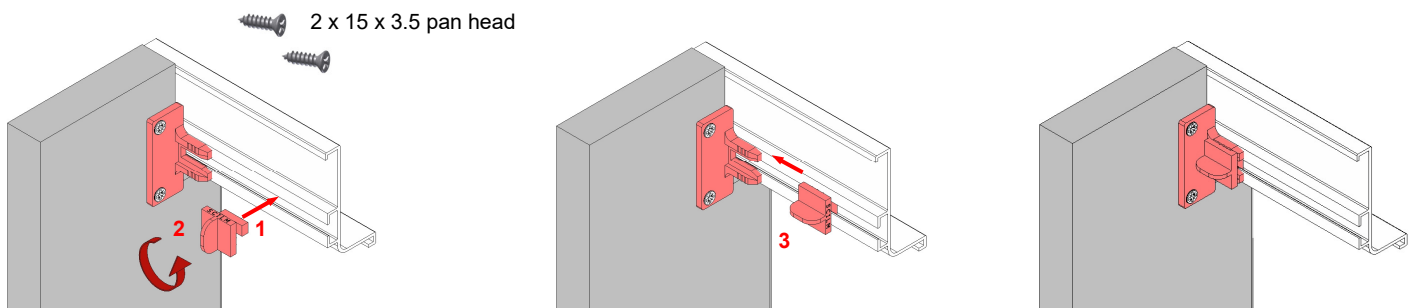

### Fixing Middle profile to carcass:

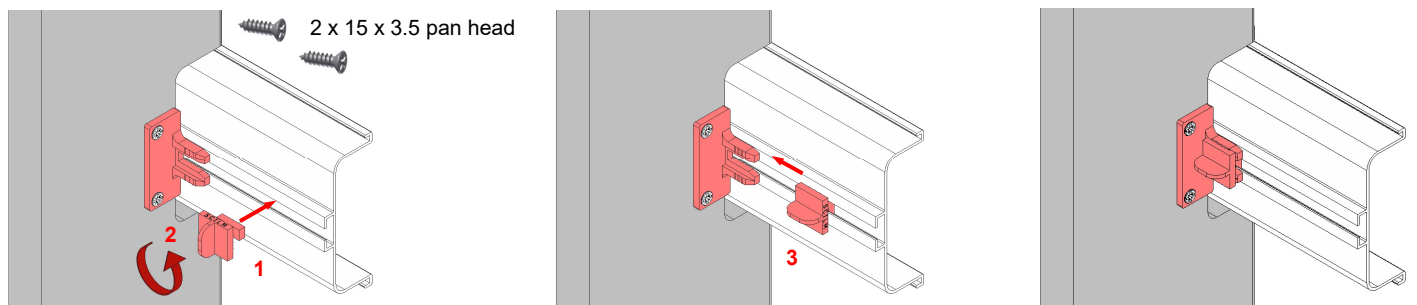

# Linear Range Installation Guide

## 1.04 Profile fitting: Base units

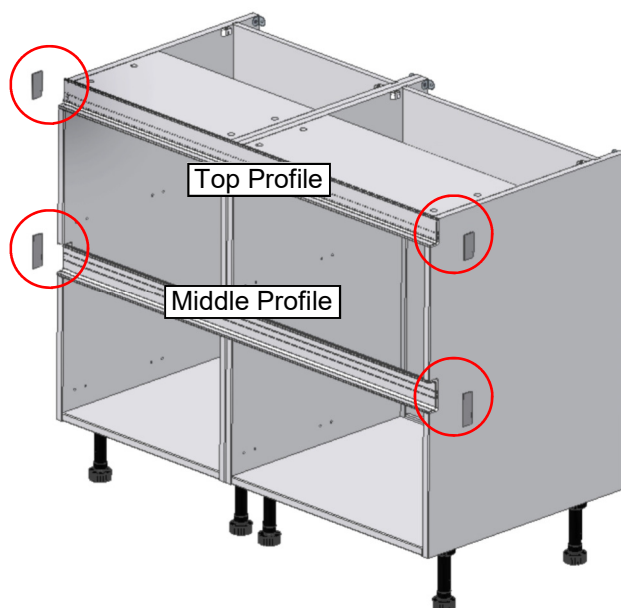

**IMPORTANT: Seal cut-outs on carcass side panels using a suitable sealer**

Diagram shows end cap option.

For optional end panel choices see

Section 1.4 Page 15—Linear Avant  
 Section 1.6 Page 22—Linear Base Blender  
 Section 1.7 Page 23—Linear Island Blender

### Top Profile - End cap - LNTOPCAP/L & LNTOPCAP/R

1.5mm Allen key required to turn grub screw

LH End Cap with grub screw



RH End Cap with grub screw

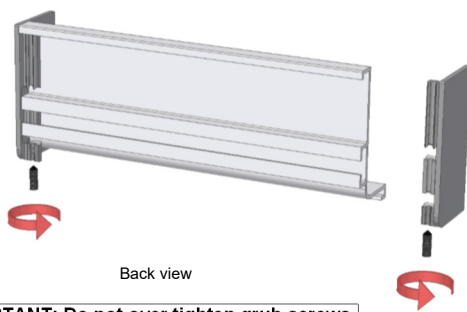

**IMPORTANT: Do not over tighten grub screws**

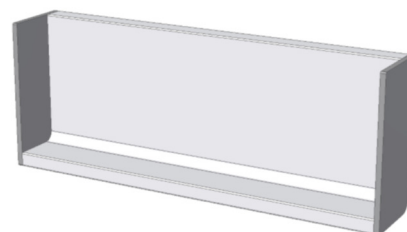

### Middle Profile - End cap - LMIDCAP

1.5mm Allen key required to turn grub screw

Middle Trim with grub screw  
 Universal—flip to fit both ends

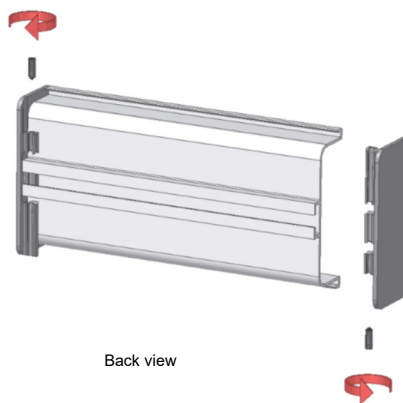

**IMPORTANT: Do not over tighten grub screws**

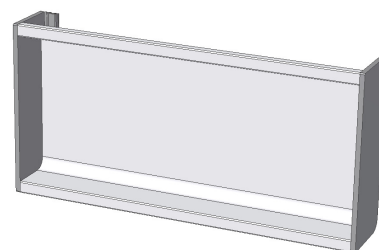

# Linear Range Installation Guide

## 1.04 Profile fitting: Base units - L Shaped

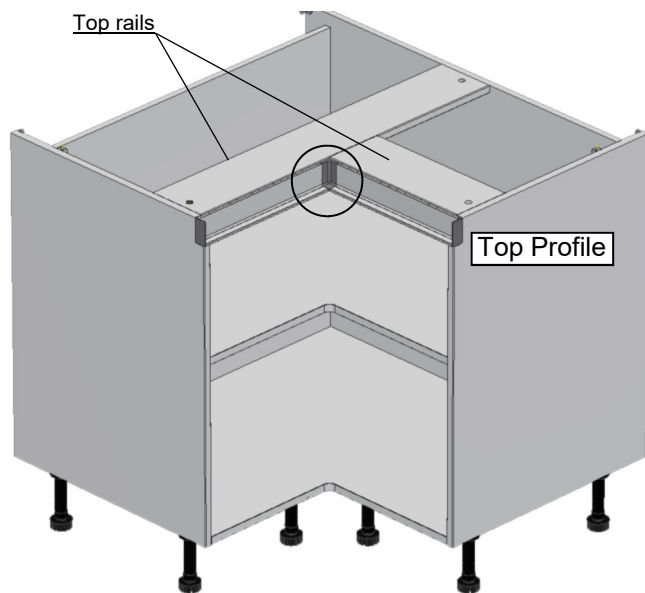

**IMPORTANT:** Seal cut-outs on carcass side panels using a suitable sealer

### **Top Profile - Internal corner - LNINTCNR & SLOTTED BRACKET & SCREWS — FPK/1142**

Pozi drive screw driver required for screws

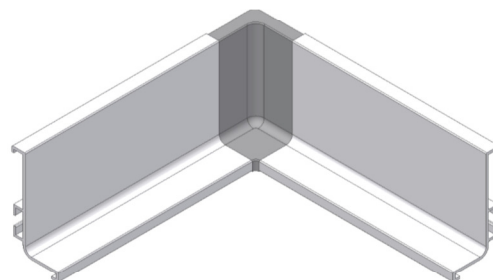
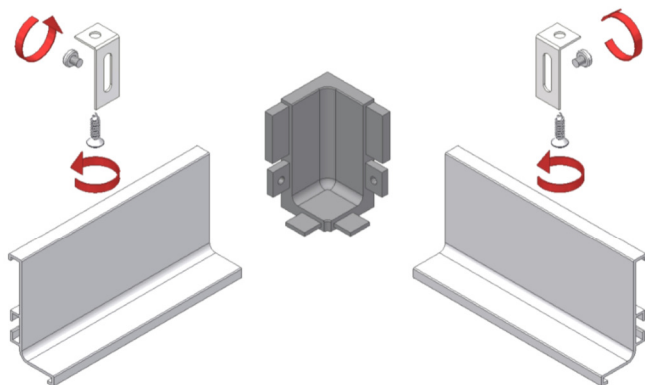

Screw into the 18mm top rails (not shown)

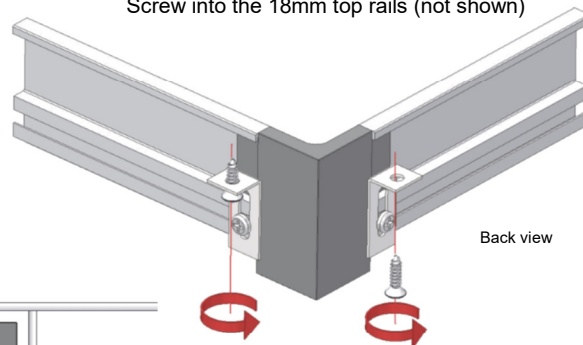
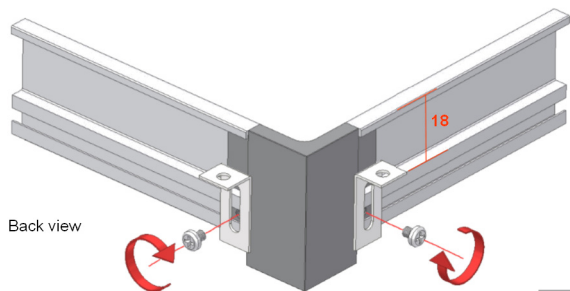

**Plan view**  
Showing the position of brackets, 18mm top rails and internal corner trim

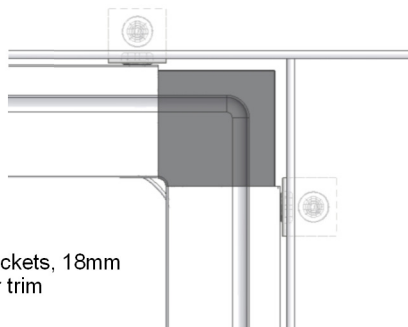

# Linear Range Installation Guide

## 1.04 Profile fitting: Base units - Corners

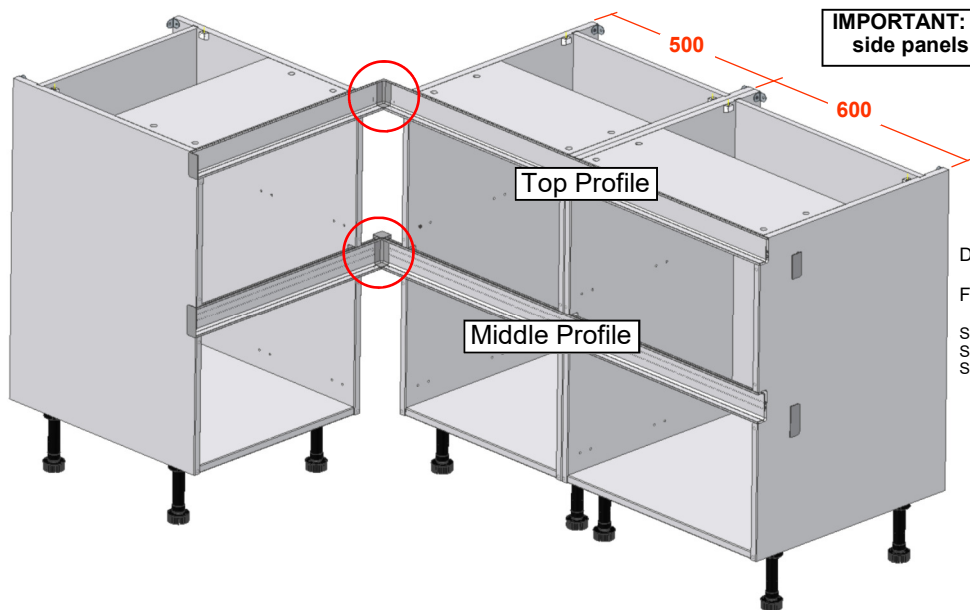
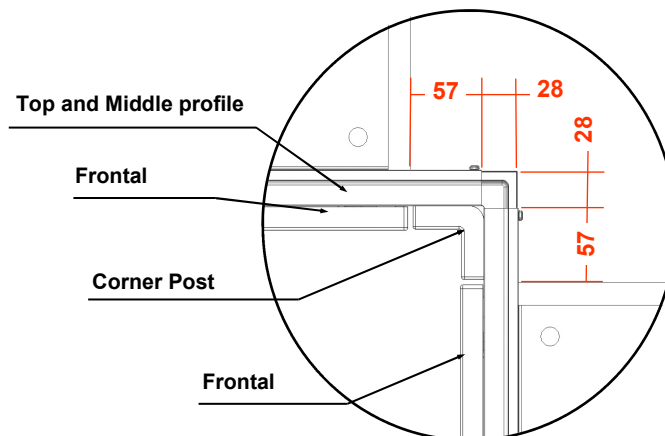
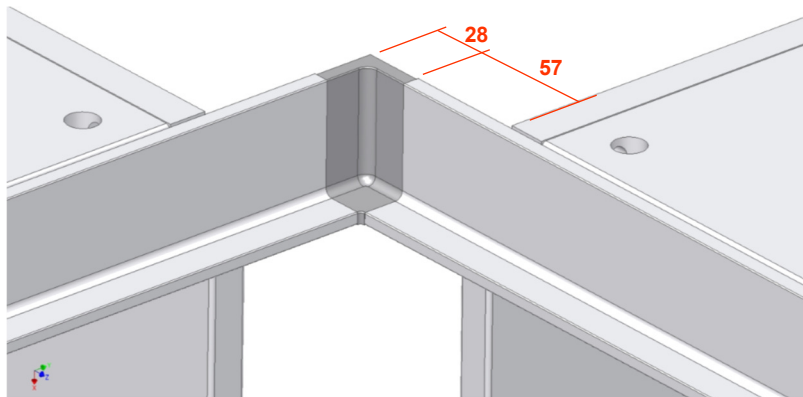

Diagram shows end cap option.  
 For optional end panel choices see  
 Section 1.4 Page 11—Linear Avant  
 Section 1.6 Page 18—Linear Base Blender  
 Section 1.7 Page 19—Linear Island Blender

### Cutting horizontal profiles to length:

**Top & Middle profile:** For standard corner dimensions of 630x630 the top profile length = base unit width plus 57mm.  
 For example the layout above = 500 + 600 + 57 = 1157mm cut profile length.

Ensure to calculated enough trim to cover corner



# Linear Range Installation Guide

## 1.04 Profile fitting: Base units - Corners

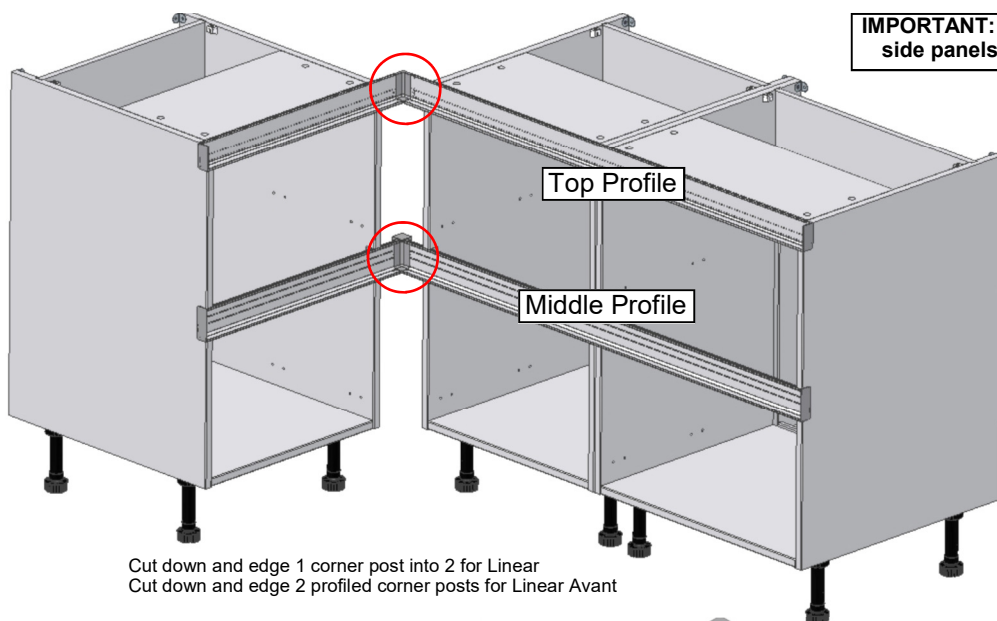

### Top Profile - Internal corner - LNINTCNR

Pozi drive screw driver required for screws

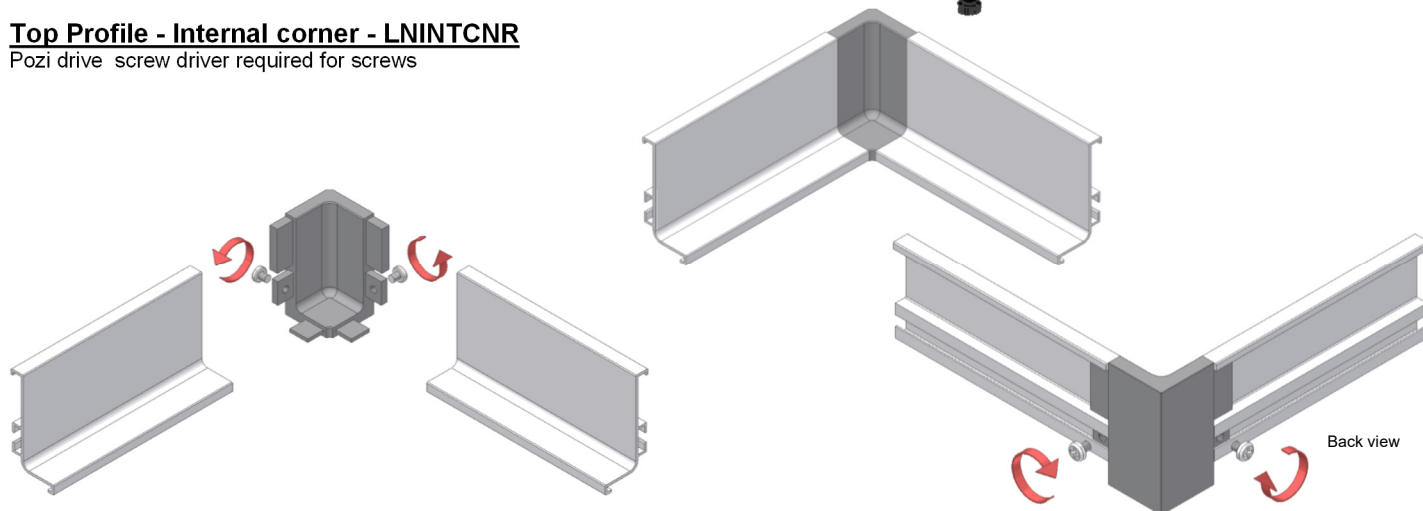

### Middle Profile - Internal corner - LMIDINTCNR

Pozi drive screw driver required for screws

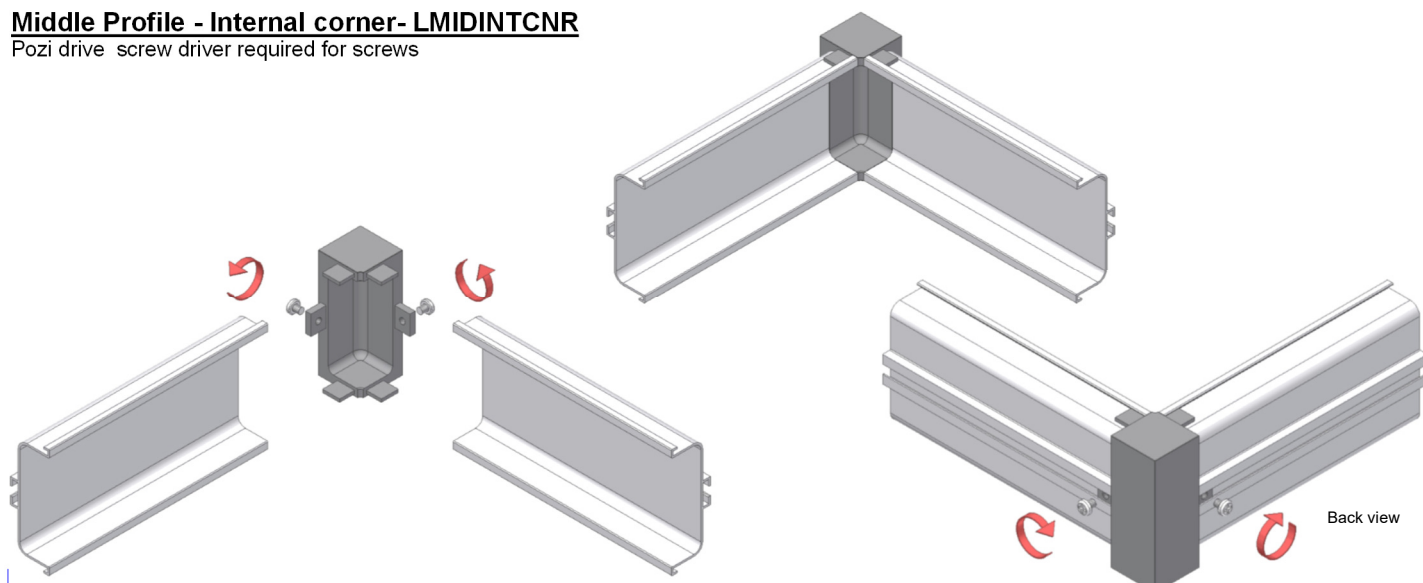

# Linear Range Installation Guide

## 1.04 Profile fitting: Base units - Corners

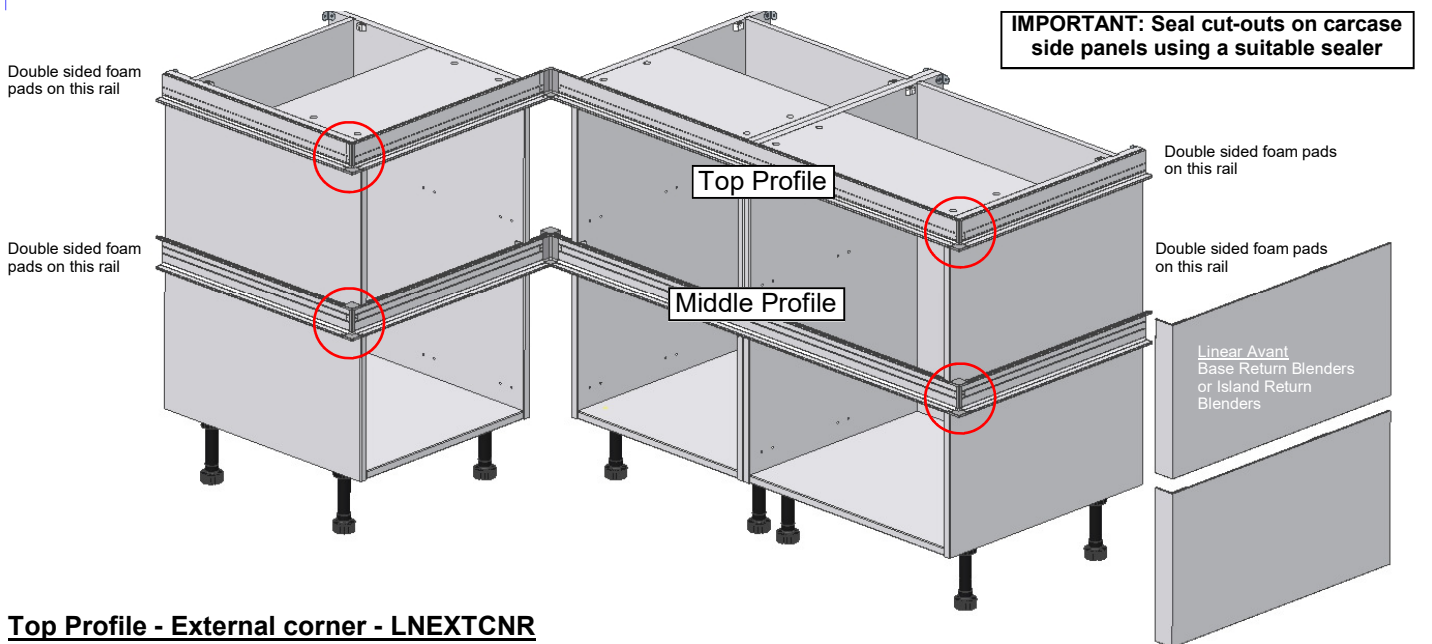

### Top Profile - External corner - LNEXTCNR

Pozi drive screw driver required for screws

Warning : the screw heads will clash with the cut-out

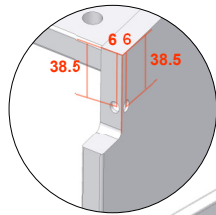
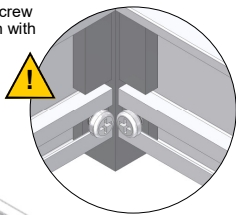

To avoid the clash, drill 2 holes to take the screw heads.  
Hole diameter = 8.0 x 2.5 to 3.0 mm deep

38.5 mm down from the cut-out top  
6.0 mm in from the outside cut-out edge.

Clear any areas that clash with screws and prevent fitting with a file.

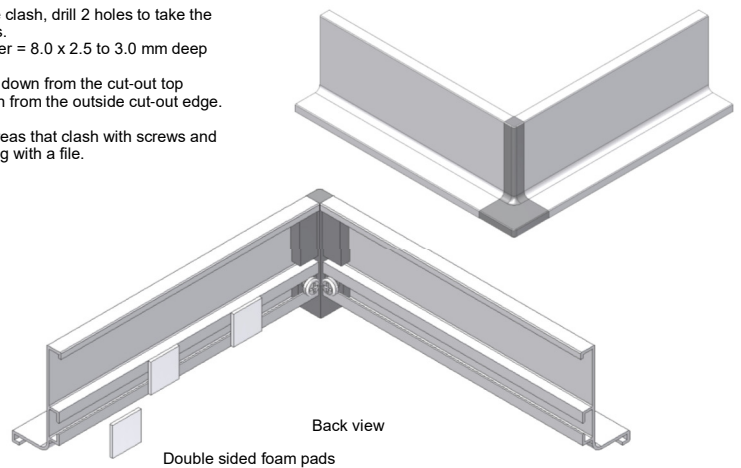
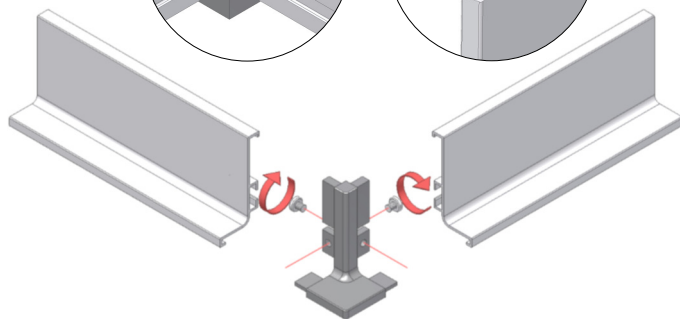

### Middle Profile - Internal corner- LMIDEXCNR

Pozi drive screw driver required for screws

Warning : the screw heads will clash with the cut-out

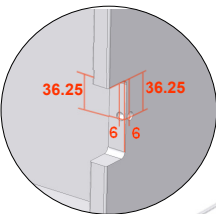
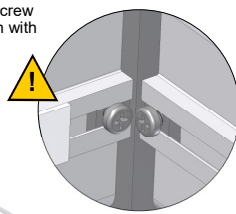

To avoid the clash, drill 2 holes to take the screw heads.  
Hole diameter = 8.0 x 2.5 to 3.0 mm deep

36.25 mm down from the cut-out top  
6.0 mm in from the outside cut-out edge.

Clear any areas that clash with screws and prevent fitting with a file.

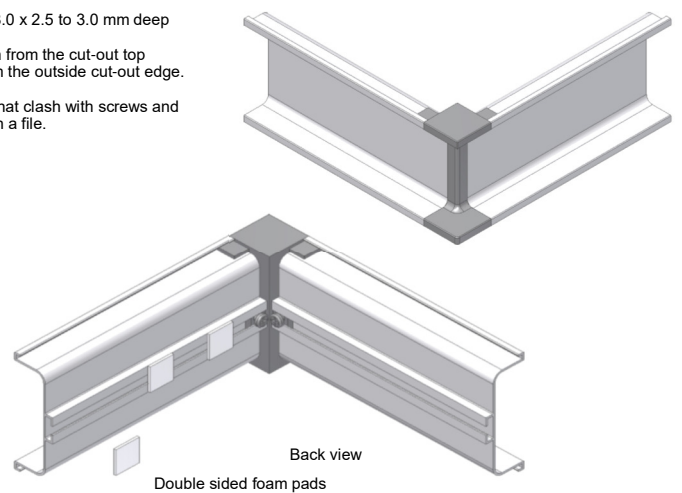
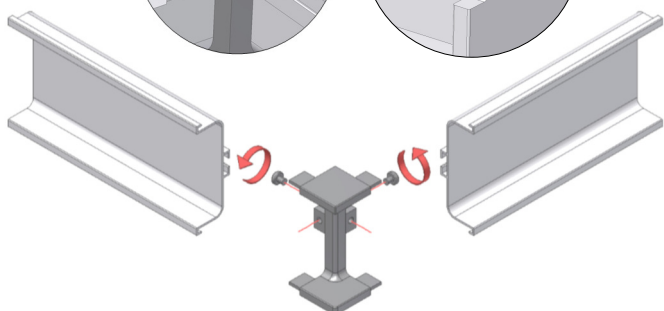

# Linear Range Installation Guide

## 1.05 Profile fitting: Tall units - Blender

Joining a LH or RH Unit to a Blender Panel use the Handle profile for stand alone tall units Code: LNENDTRIM22.

Position the tall unit with reduced depth side panel (558) to face the Blender Panel (590 nom), ready for the fitting of this aluminium handle profile.

Before fitting, the handle profile needs to be cut to the unit height using a sharp fine toothed blade.

From Fitting pack FPK1129 screw the Z and the X brackets to one of the units using the screws provided.

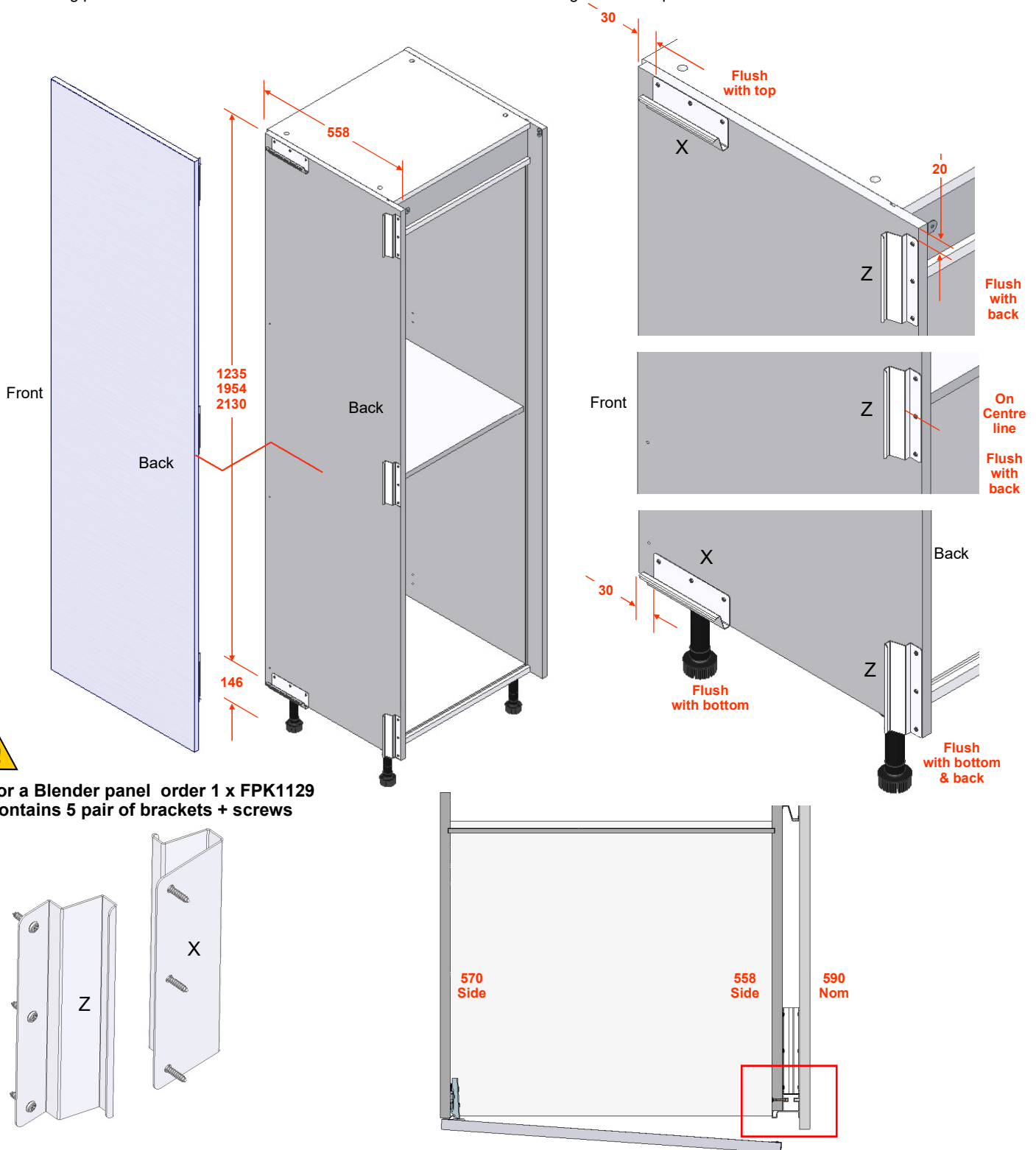



# Linear Range Installation Guide

## 1.05 Profile fitting: Tall units - Blender

From Fitting pack FPK1129 screw the Z and the X brackets to the Blender Panel using the screws provided.

Slide the units together so that the X and Z brackets interlock.

Fit the profile to the front of the units as shown. Drill through reduced depth side panel and screw in place using countersunk self tapping 25 x 4.2 screws.

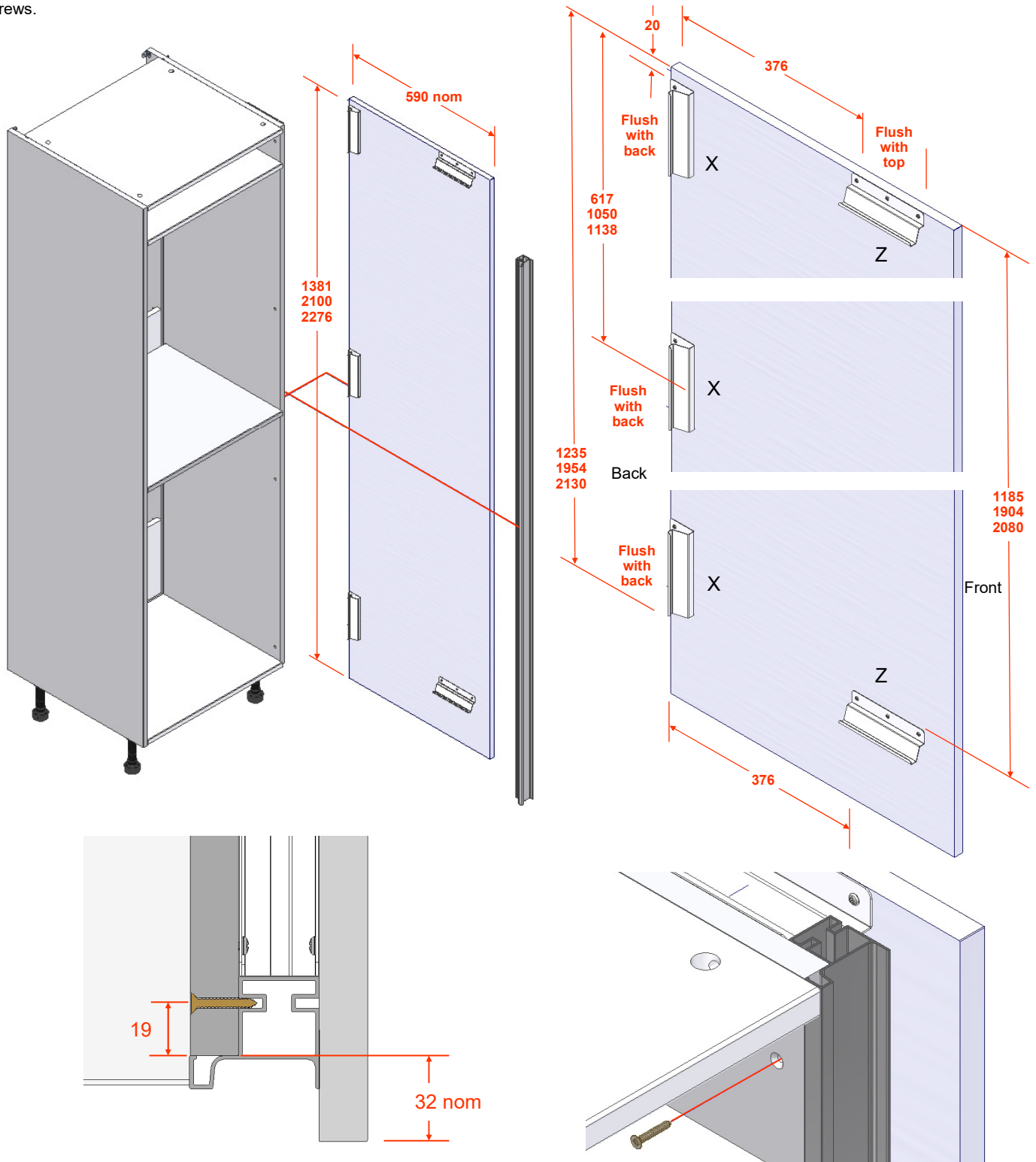

Front Profile screws: Qty 8, 25x4.2 CSK in FPK008. Supplied with the profile

# Linear Range Installation Guide

## 1.05 Profile fitting: Tall units - End Trim

Joining a LH and a LH Unit or a RH and RH Unit together use the Handle profile for stand alone tall unit Code: LNENDTRIM22.

Position the tall unit with reduced depth side (558) to face the unit with a full side (570) ready for the fitting of this aluminium handle profile.

Before fitting, the handle trim needs to be cut to the unit height using a sharp fine toothed blade.

From Fitting pack FPK1128 screw the Z brackets to one of the units using the screws provided.

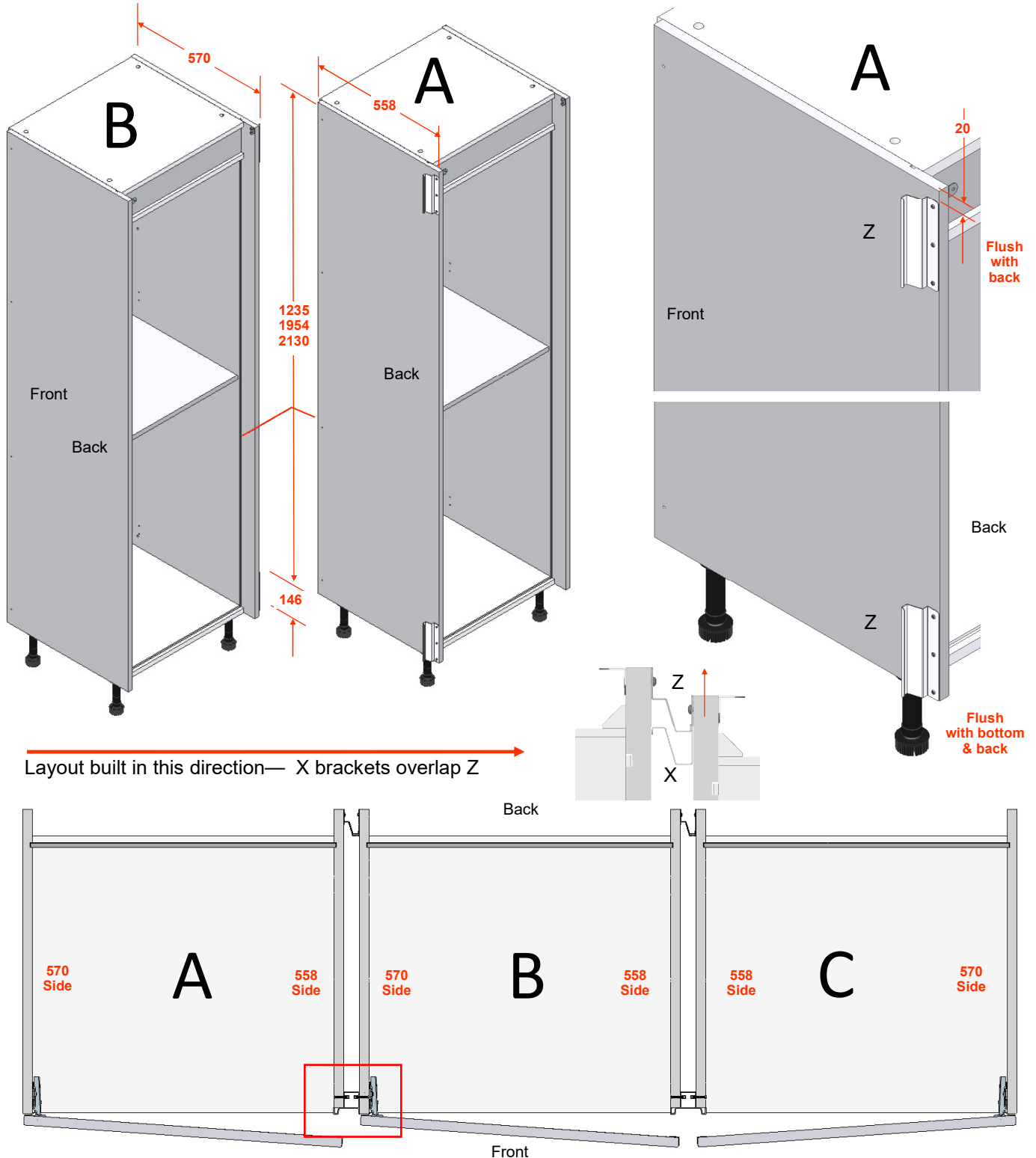

# Linear Range Installation Guide

## 1.05 Profile fitting: Tall units - End Trim

From Fitting pack FPK1128 screw the X brackets to the other units using the screws provided.

Slide the units together so that the X and Z brackets interlock.

Fit the profile to the front of the units as shown. Drill through the side panels and screw in place using countersunk self tapping 25 x 4.2 screws.

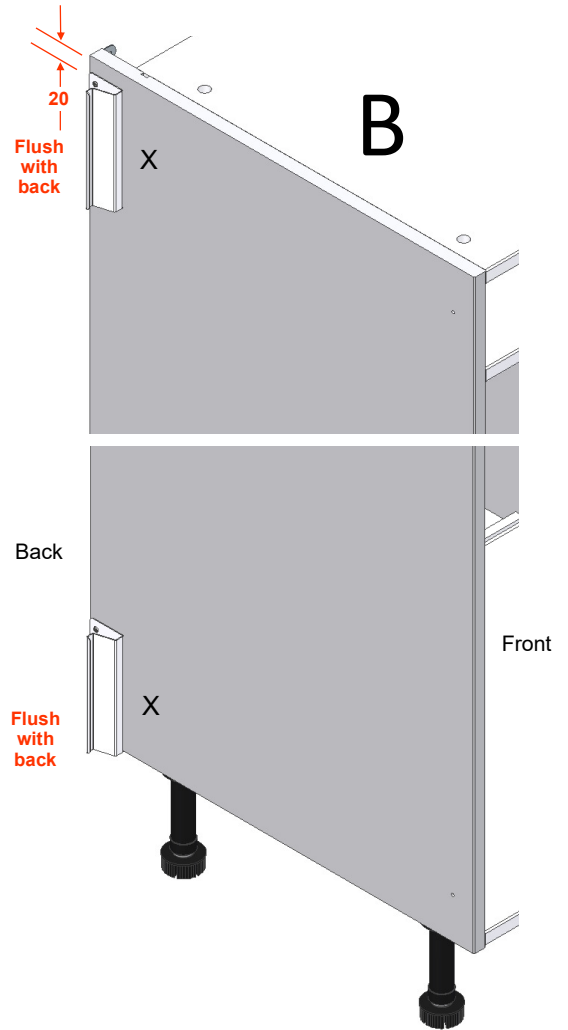
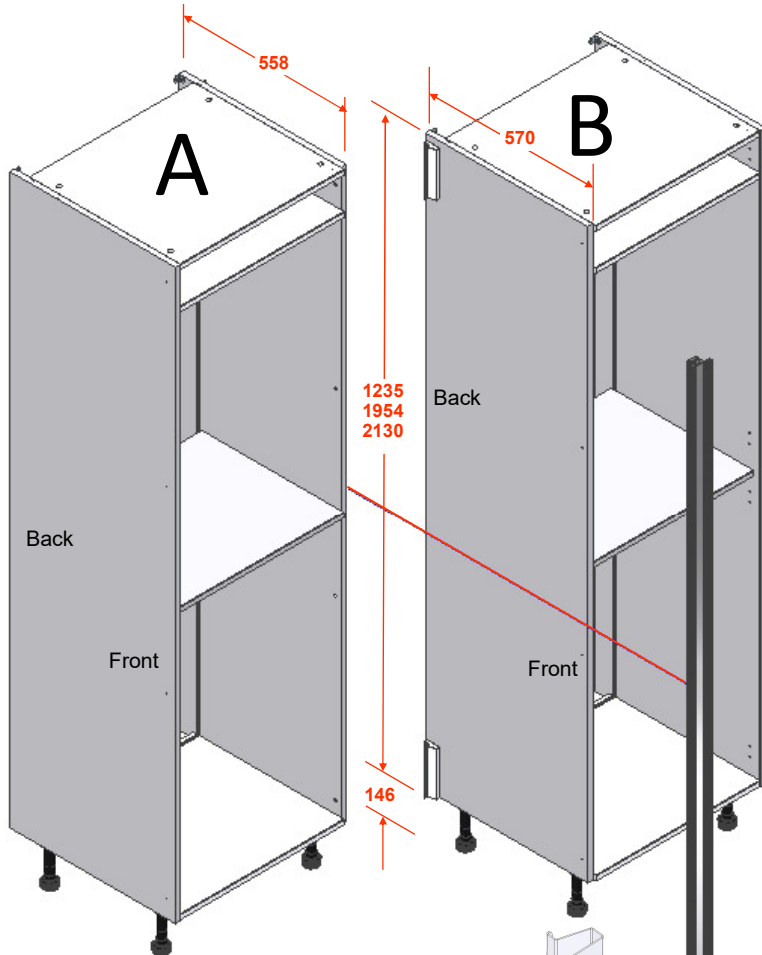

For a Tall Unit order 1 x FPK1128  
Contains 2 pair of brackets + screws

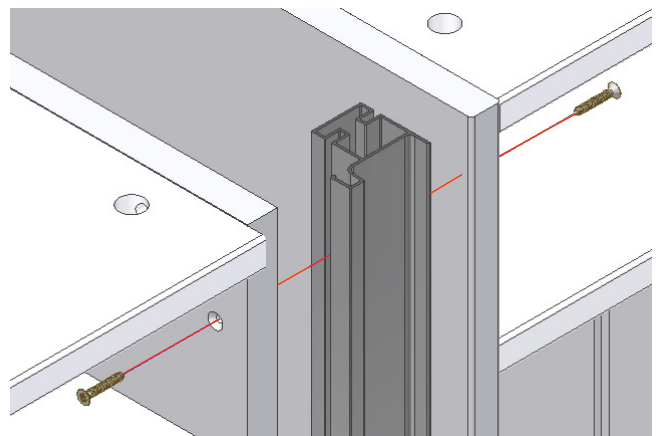
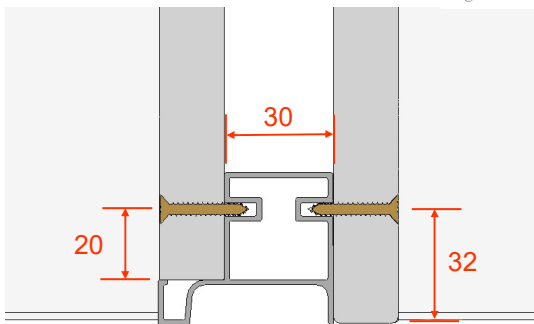
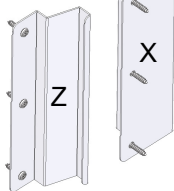

Front Profile screws: Qty 8, 25x4.2 CSK in FPK008. Supplied with the profile

# Linear Range Installation Guide

## 1.05 Profile fitting: Tall units - Centre Trim

Joining a LH and a RH Unit together use the Handle profile for side by side tall units: Code: LNCTRTRIM22 .

Position the tall units together with reduced depth side panel (558) facing each other, ready for the fitting of this aluminium handle profile.

Before fitting, the handle profile needs to be cut to the unit height using a sharp fine toothed blade.

From Fitting pack FPK1128 screw the Z brackets to one of the units using the screws provided.

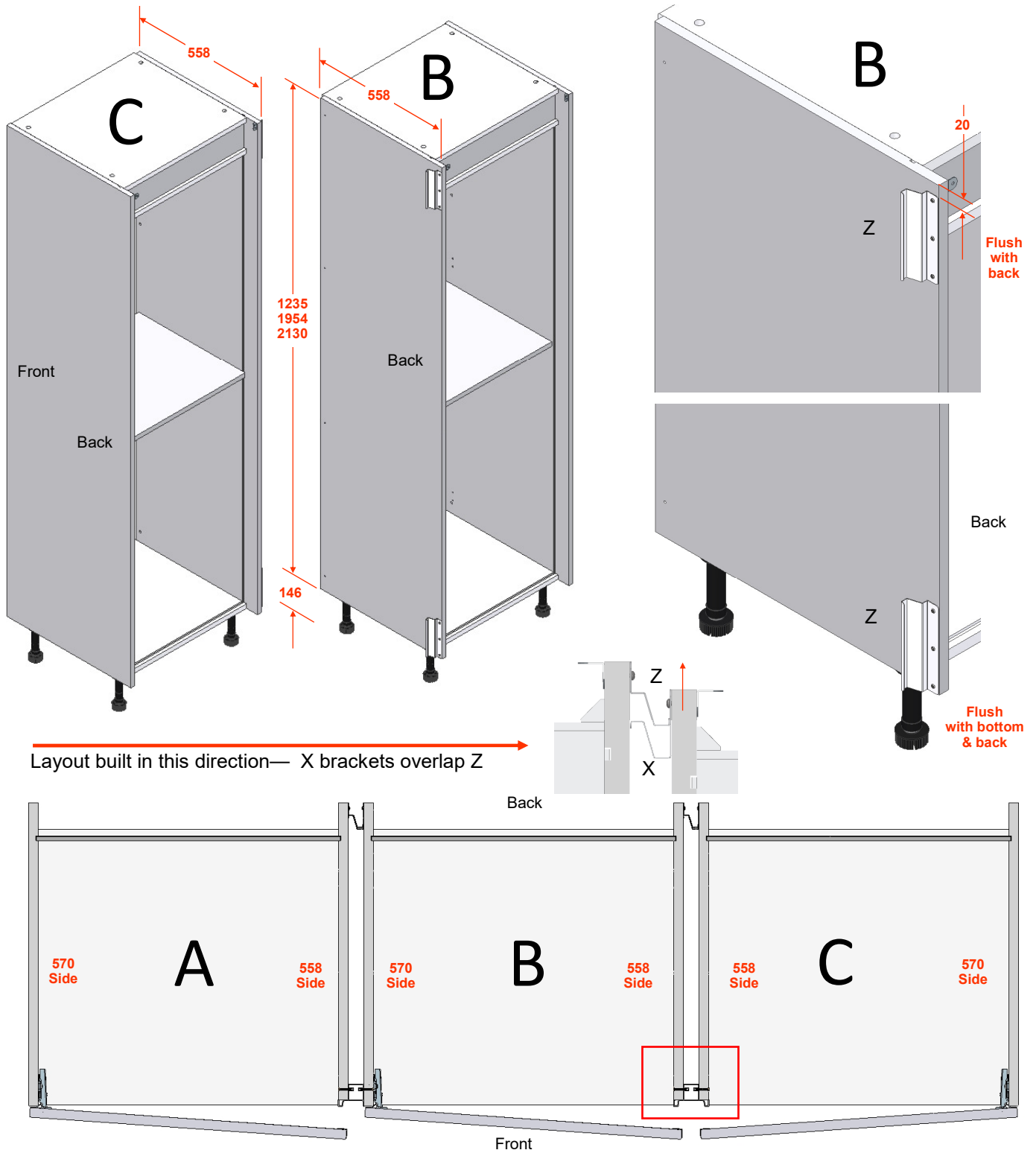

# Linear Range Installation Guide

## 1.05 Profile fitting: Tall units - Centre Trim

From Fitting pack FPK1128 screw the X brackets to the other units using the screws provided.

Slide the units together so that the X and Z brackets interlock.

Fit the profile to the front of the units as shown. Drill through the side panels and screw in place using countersunk self tapping 25 x 4.2 screws.

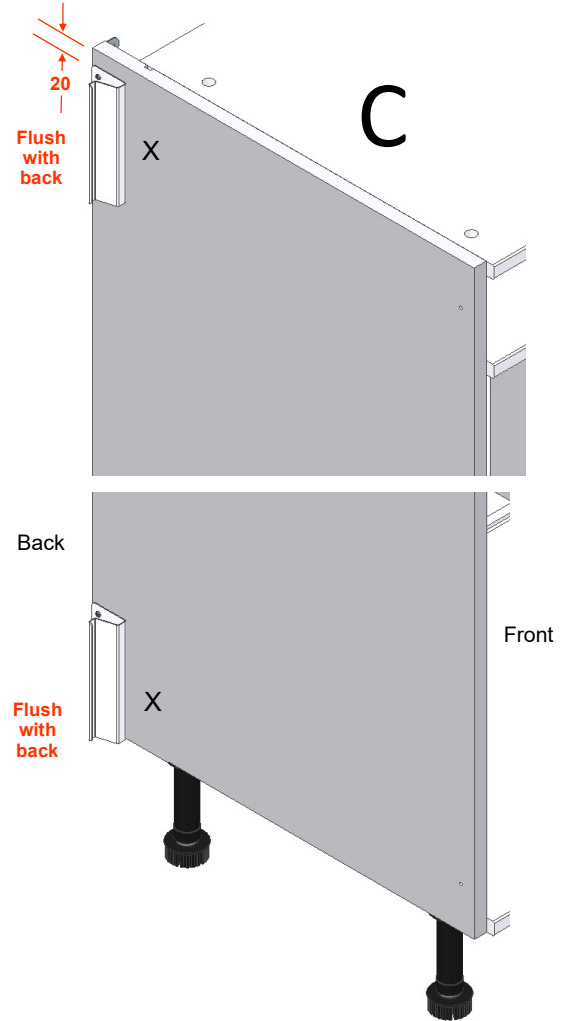
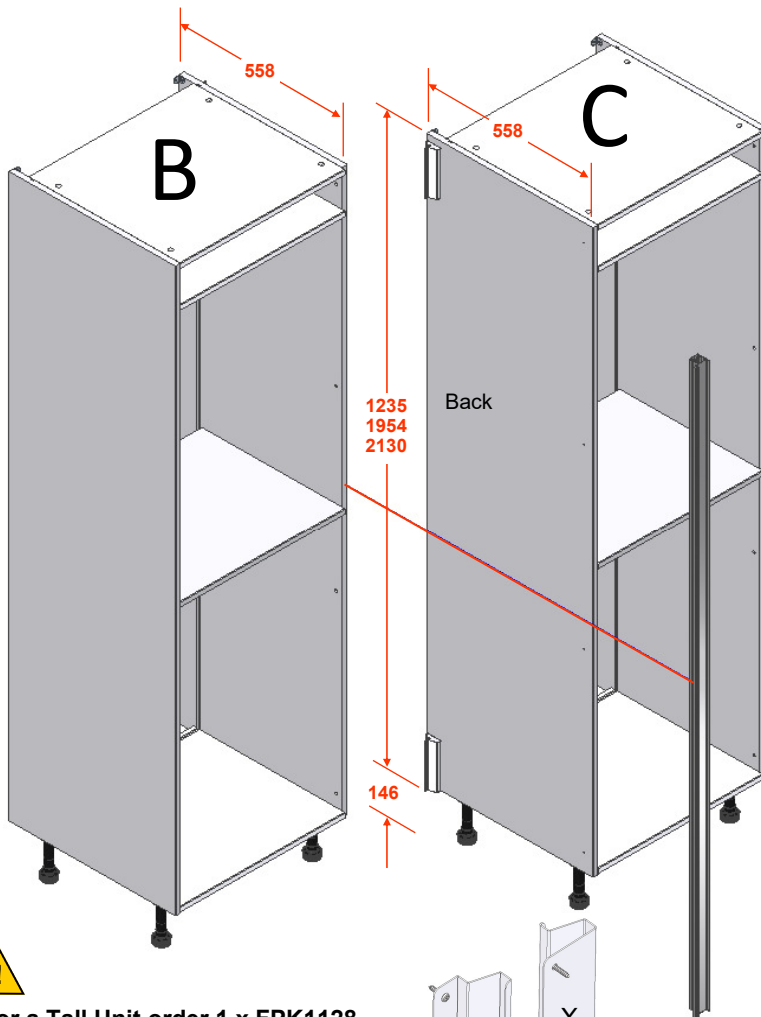

For a Tall Unit order 1 x FPK1128  
Contains 2 pair of brackets + screws

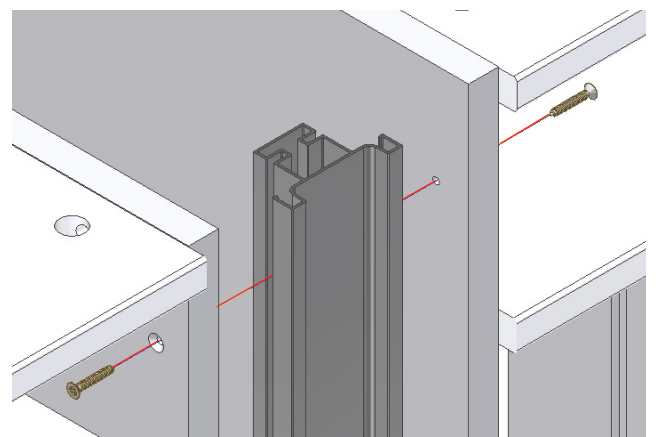
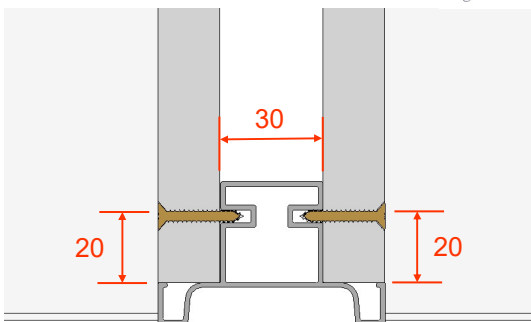
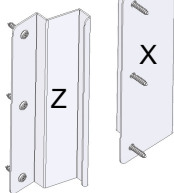

Front Profile screws: Qty 8, 25x4.2 CSK in FPK008. Supplied with the profile

# Linear Range Installation Guide

## 1.06 Blender panel: Base end return

Base end return panels are designed to fit standard base units. The panel is supplied 50mm deeper than a standard base unit to allow for extra deep worktop runs where large pipe voids are required behind the base units.

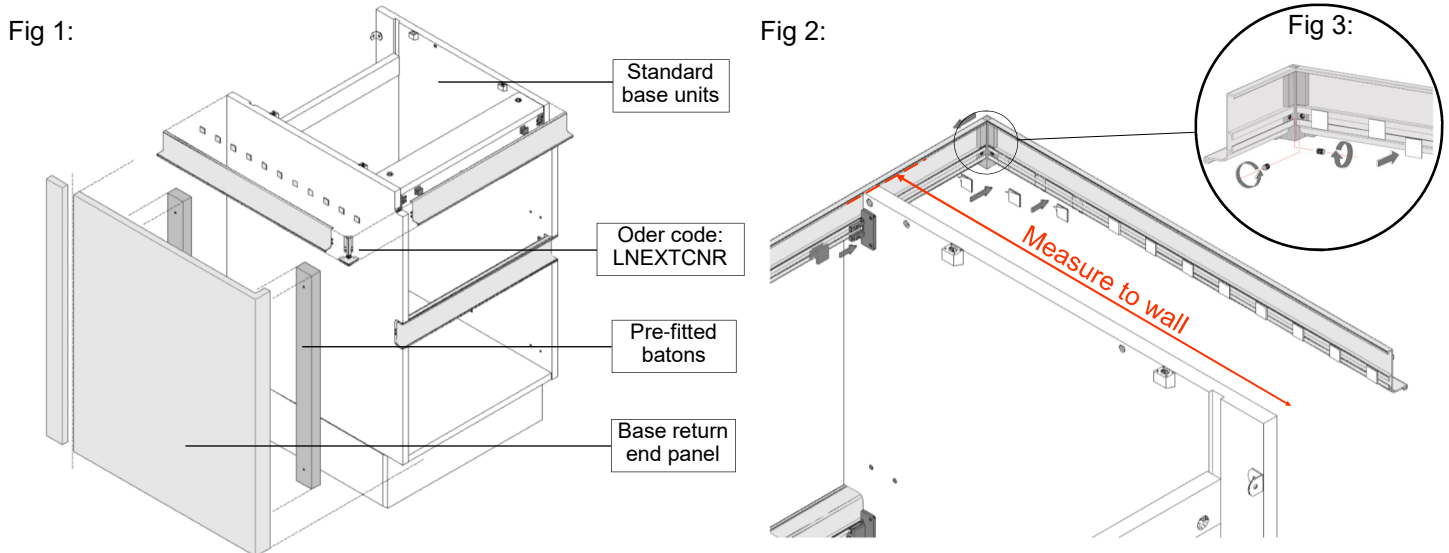

**Fig 1:** Exploded view of base end return panel, profile and components. Please remember to fit return plinth. **Fig 2:** Cut a length of 'L' shape handle trim to length by measuring the return distance to wall & fit sticky foam pads every 50mm as illustrated. **Fig 3:** Fit the external corner joint to return profile and with grub screws before securing the handle trim in position.

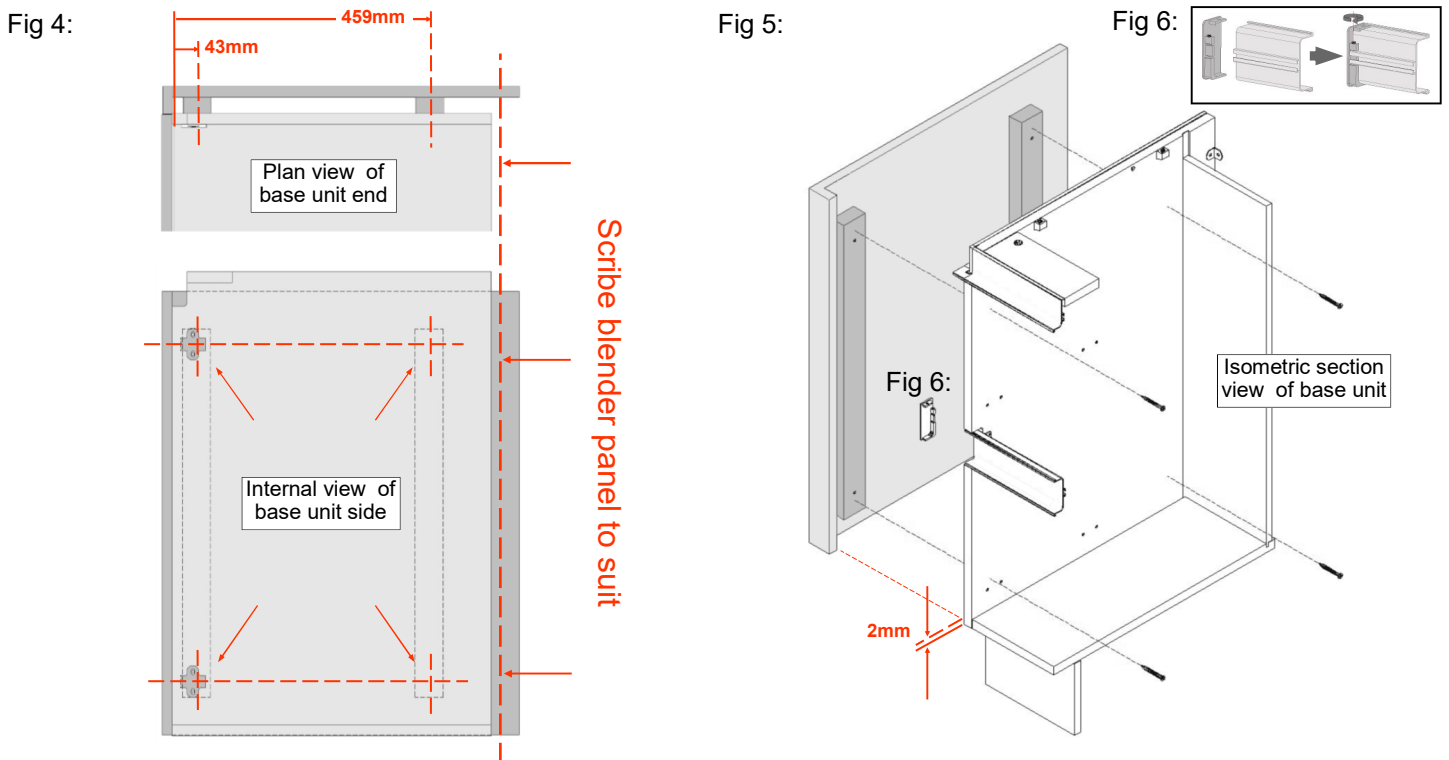
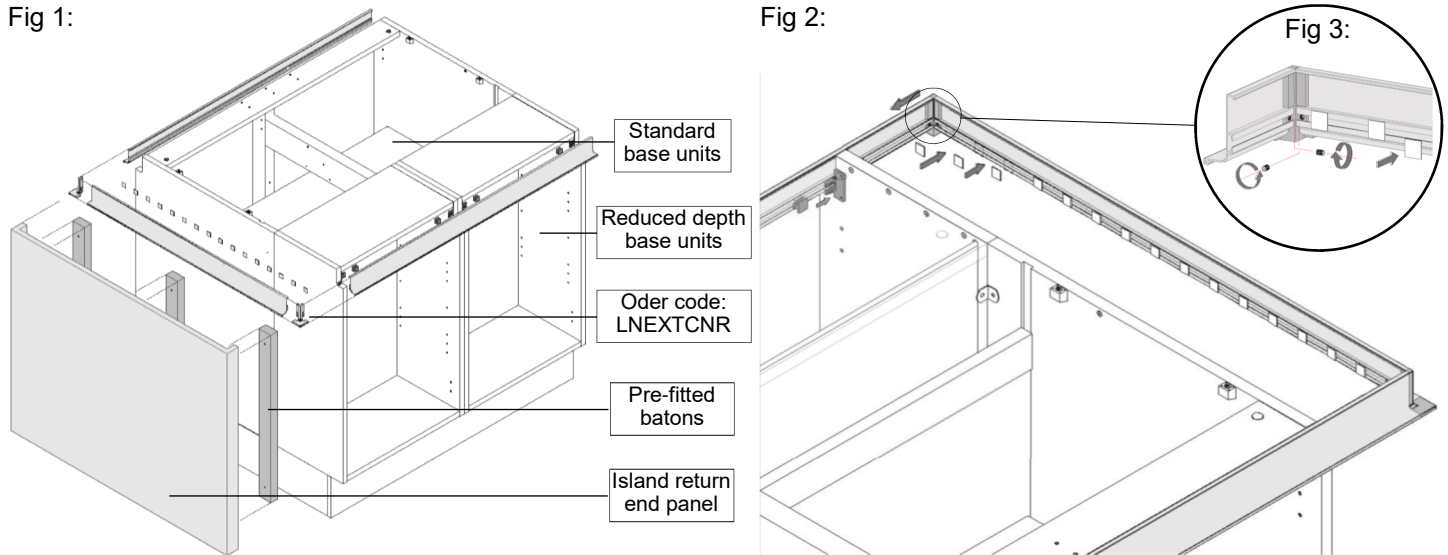

**Fig 4 & 5:** Scribe blender panel as required. Position blender panel 2mm up from bottom edge of base unit. Screw fit through base unit side panel using 40mm pozi wood screws - Pilot drill first. **Fig 6:** If the end unit incorporates a middle handle trim for drawer units this should be capped with: LNMIDCAP before fitting the blender panel.

# Linear Range Installation Guide

## 1.07 Blender panel: Island end return

Island blender panels are designed to fit standard base units fitted back to back with reduced depth base units.



**Fig 1:** Exploded view of Island blender panel, profile and components. Please remember to fit return plinth. **Fig 2:** Cut a length of 'L' shape handle trim to exactly 803mm & fit sticky foam pads every 50mm as illustrated. **Fig 3:** Fit both external corner joints to return profiles and with grub screws before securing the handle trim in position.

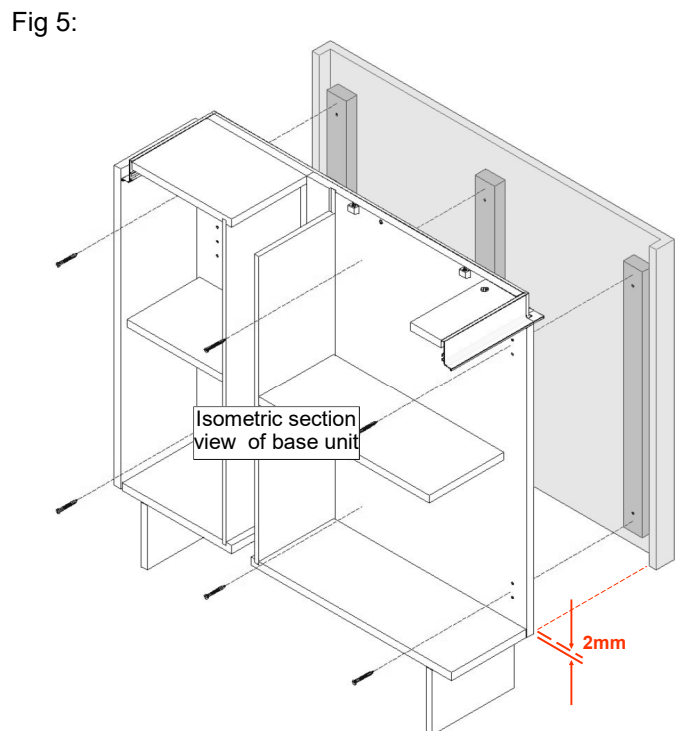
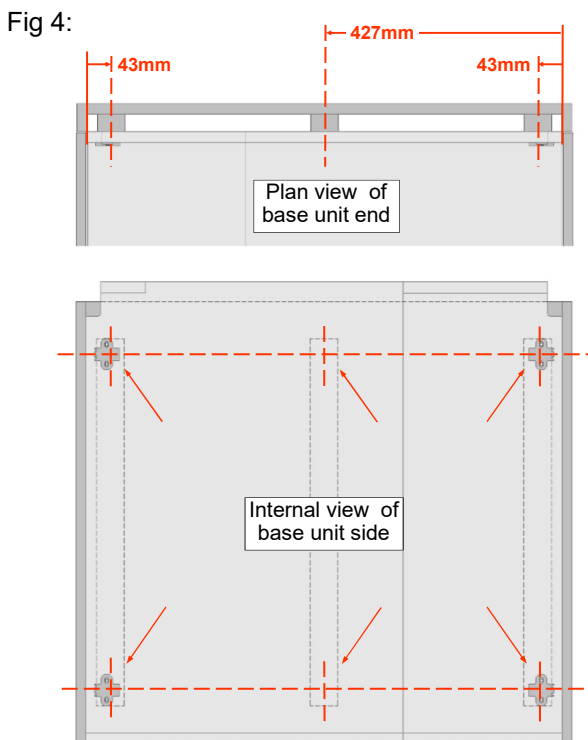
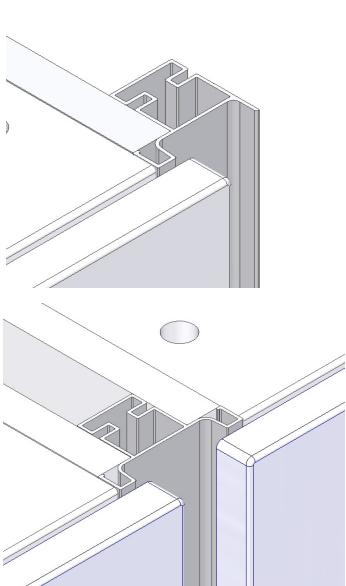

**Fig 4 & 5:** Position blender panel 2mm up from the bottom edge of the base unit. Screw fit through base unit side panel using 40mm pozi wood screws - Pilot drill first. **Fig 6 (see page 11):** If the end unit incorporates a middle handle profile for drawer unit this should be capped with: LNMIDCAP before fitting the blender panel.

# Linear Range Installation Guide

## 1.08 Fixing Cap: Oven Housings

Tall Oven housings with profiles require a Oven Fixing Cap to help secure the oven in place. This provides a wider 17mm flange to screw into. Fixings supplied with the oven will vary in type and quantity. The images shown are a guide to fixing only. Additional self tapping screws may be required. The screw head detail should match the screws provided by the manufacturer.



The Oven Fixing Strip gives a wider flange to screw into for both the Tall profiles.

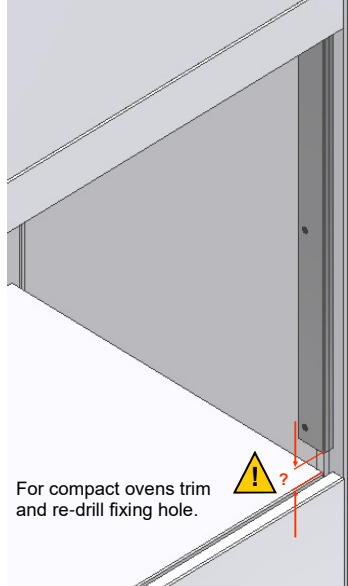

For compact ovens trim and re-drill fixing hole. Measure the Oven Fixing Cap against the oven position. Position will vary depending upon the oven.

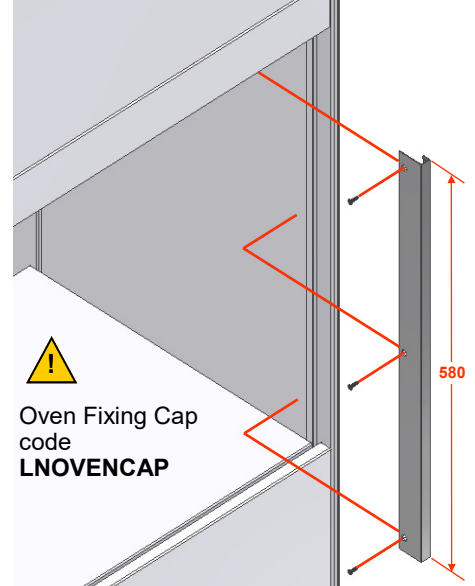

Screw the strip in place using the screws provided.

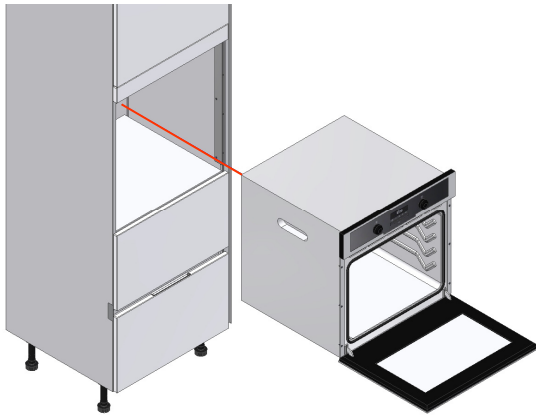

Fit the oven into the unit and ensure the Cap is in the correct position.

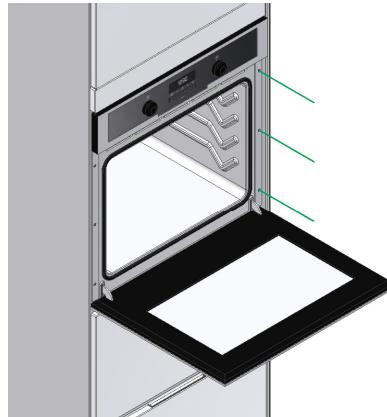

Use the fixing positions in the Oven to mark the Cap ready for drilling.

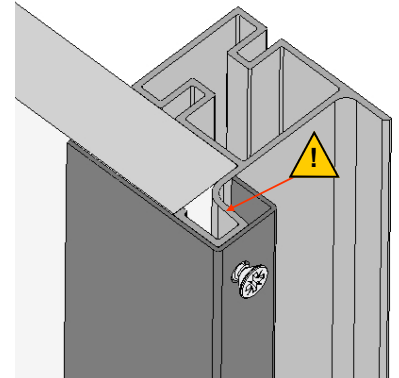

Use a suitable drill for the self tapping screws. Drill through both the Cap and the Tall Trim. Take extra care if the hole lines up with edge of the trim.

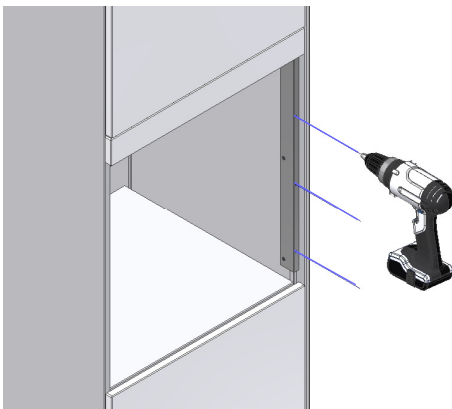

Drill the fixing Cap.



Screw the oven to the MFC side using the screws supplied by the Oven manufacturer

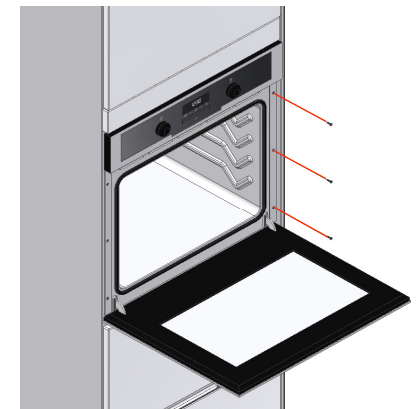

Screw the oven to the Oven Fixing Cap using suitable self tapping screws.



# Linear Range Installation Guide

## 1.09 Integrated appliance fitting: Base Unit

Generally most integrated appliances adjust between 820-880mm. Please ensure the chosen appliance conforms to an installation height of 842mm prior to ordering.

When planning built under fully integrated washing machines & dishwashers in Linear, an additional panel & fixings are required to aid installation & prevent to appliance from tipping.

Supply the following items in addition to the frontal & appliance:

- Additional Panel ESP6592 - Quantity x 1 - 920 x 650 x 18mm - *to be cut onsite to suit*
- Fitting Pack FPK/791 - Quantity x 2

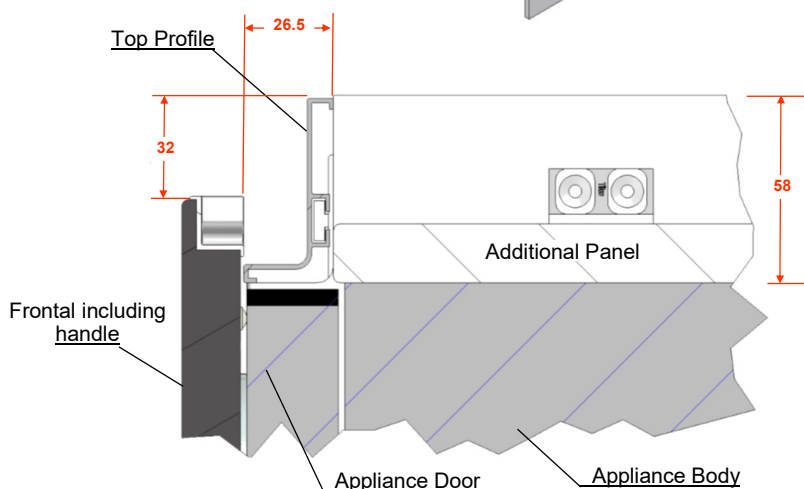
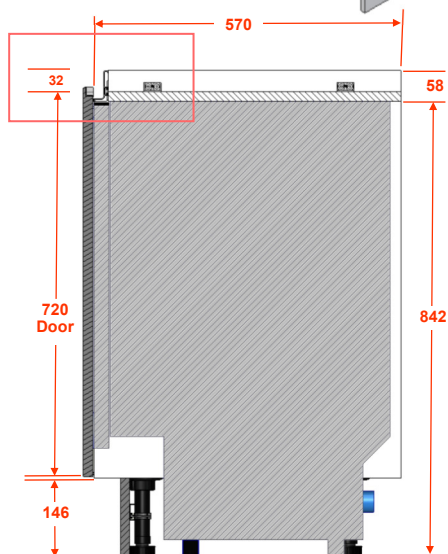
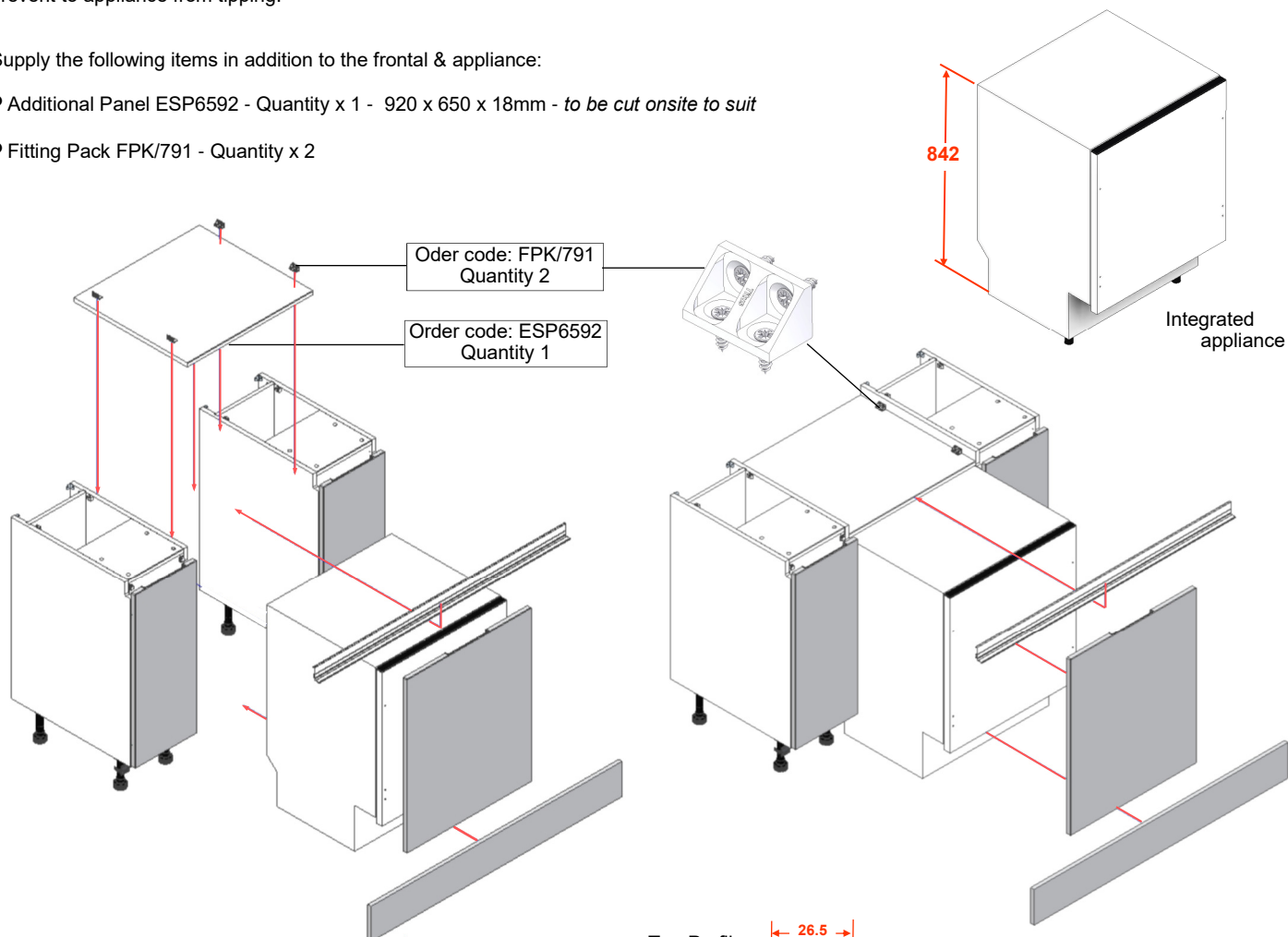

**Please note**

Linear doors shown with inset handle shown, not all Linear door ranges have an inset handle

# Linear Range Installation Guide

## 1.10 Base Units: Filler Options

### Option A — End panel & scribe ( Full height 2 drawer units )

Fitter to supply fixings to attach filler panels

Blender panel to be used as filler

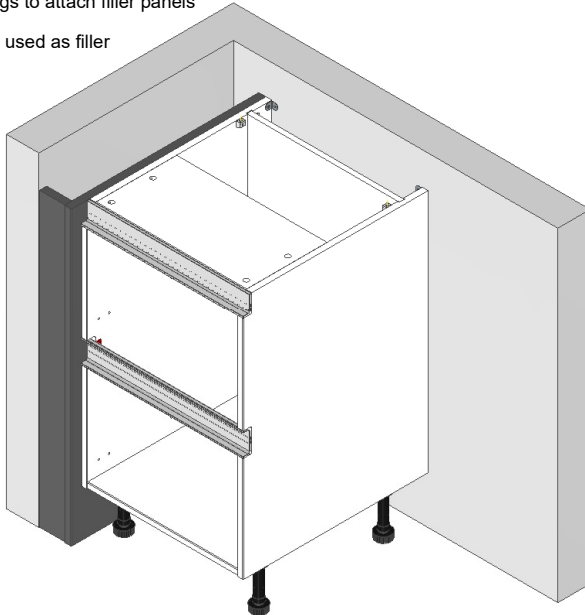

The Horizontal trims run directly up to the Blender panel  
There is no need to supply trim end caps

Plinth runs into blender panel

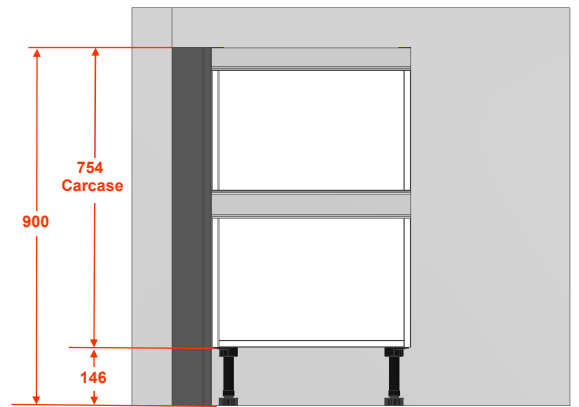
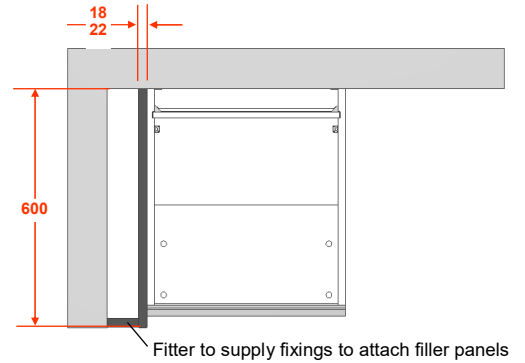

### Option B — Decorative Filler ( Full height 2 drawer units )

Fitter to supply fixings to attach filler panels

The Top and middle Trims run into wall.  
Trim end caps are optional.

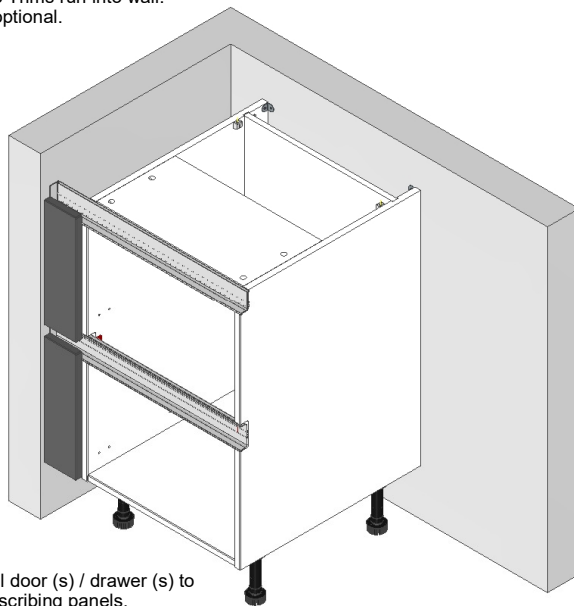

Supply an additional door (s) / drawer (s) to be used as the two scribing panels.

Plinth runs into directly into the wall

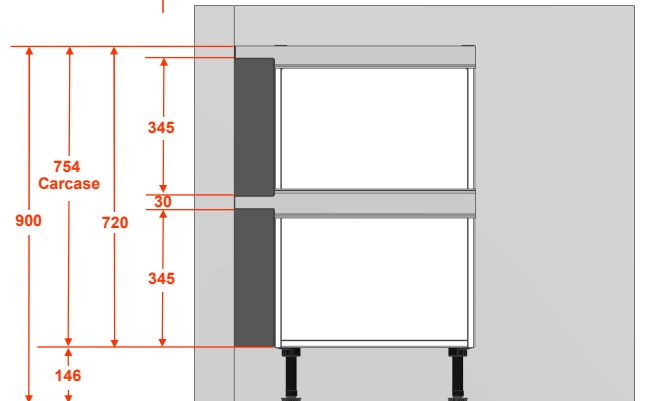
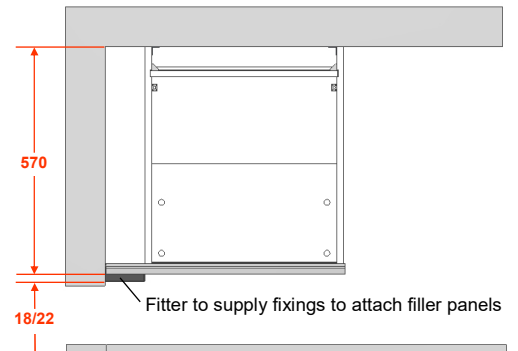

# Linear Range Installation Guide

## 1.11 Tall Units: Filler Options

### Option A — End panel & scribe

Plinth or Blender panel to be used as filler

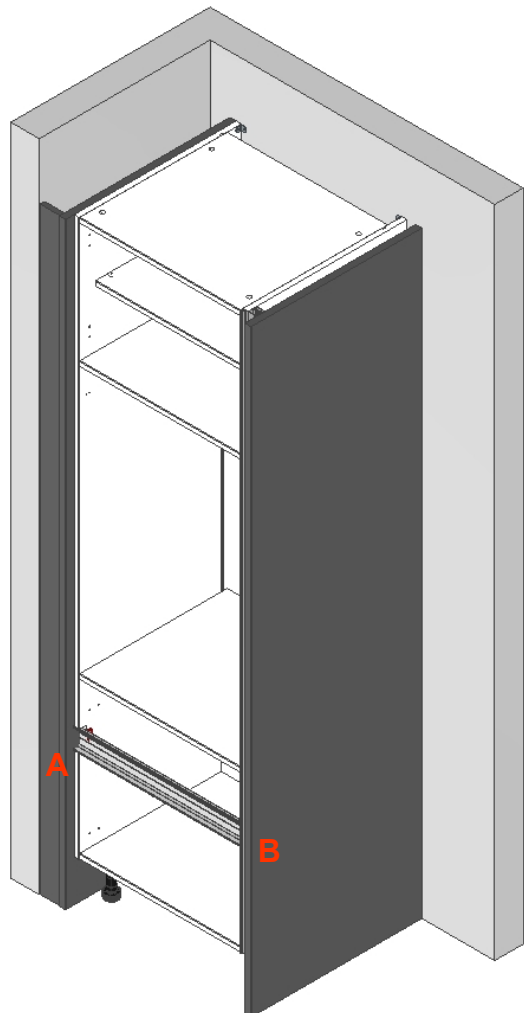

**A** When the Horizontal trim (s) run directly into blender panel  
There is no need to supply trim end caps

**B** When the Horizontal trims run directly into the Vertical Aluminium Trim  
then Trim end caps are recommended to avoid seeing the carcass side.

### Option B — Decorative Filler

Plinth or Blender panel to be used as filler

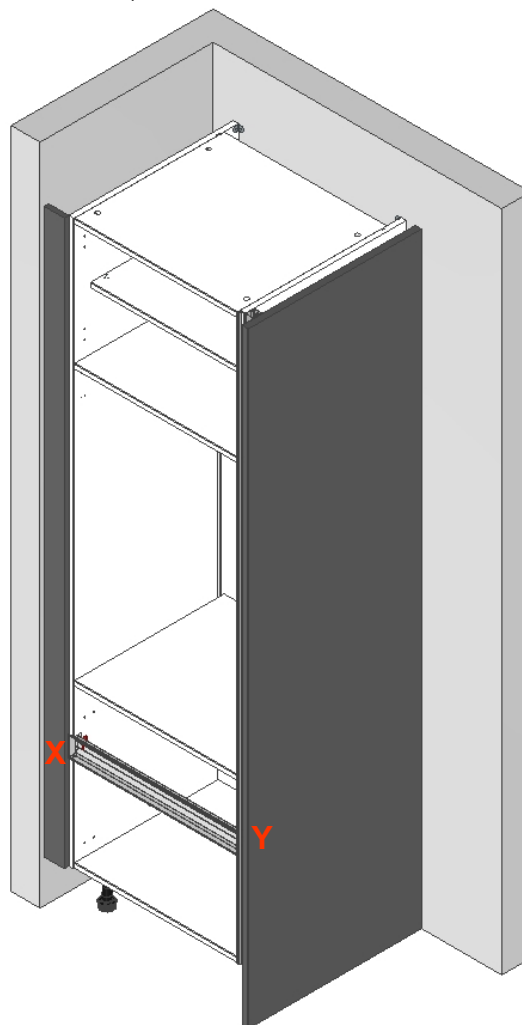

**X** When Horizontal trim (s) run directly up to the Front filler  
then Trim end caps are recommended to avoid seeing a gap.

**Y** When the Horizontal trims run directly into the Vertical Aluminium Trim  
then Trim end caps are recommended to avoid seeing the carcass side.

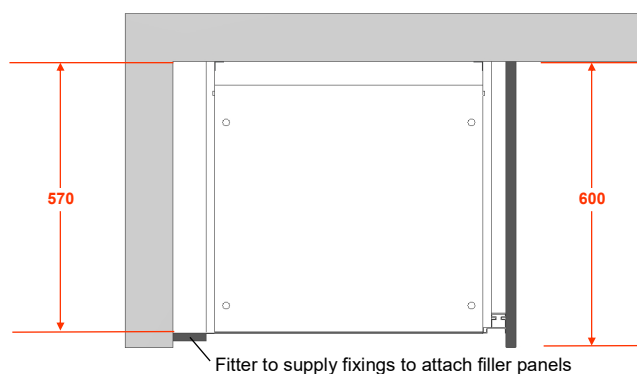
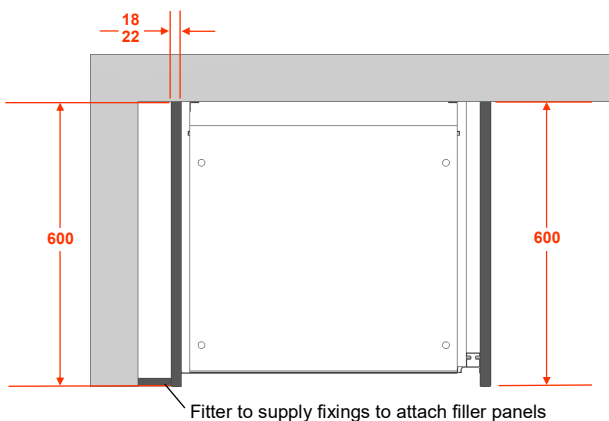

Symphony®